

Gesamtkunstwerk

A total work of art.

Lyssa Castonguay

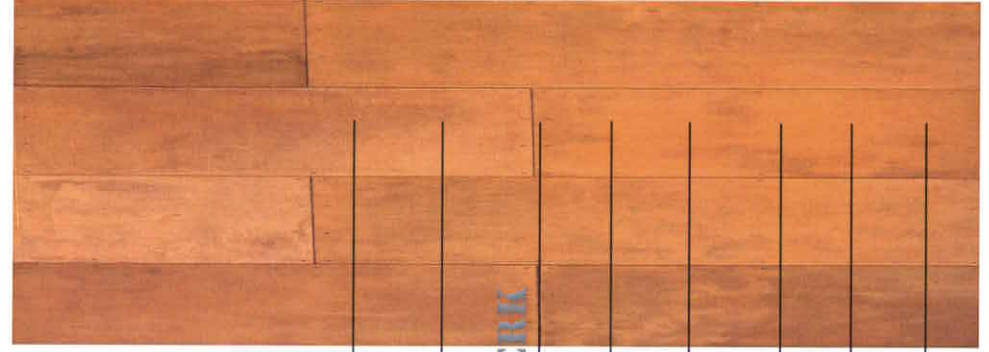

PROGRAM

SITE

GESAMTKUNSTWERK

DESIGN

EXPERIENCING

EXPLORING

ILLUMINATION

CONCLUSION



The strongly traditional library typology has undergone little transformation with regard to the catalyst of technology. Yet modern needs call for a place for the active transfer of information in all media. The architecture of a library must exemplify civic space and display its diverse offerings as there is none other than interest and free will that causes one to enter. Upon entry the architecture ought to invite the visitor to travel paths along which he will discover information he may not have been searching for.



PROGRAM

A significant change has taken place in the way information is accessed and ingested. While much of this has been absorbed by schools, libraries need to keep pace with the changes through an examination of their facilities.

© 1998 Randy Glasbergen. E-mail: randyg@norwich.net
<http://www.borg.com/~rjgtoons/toon.html>



"It's called 'reading'. It's how people install new software into their brains."

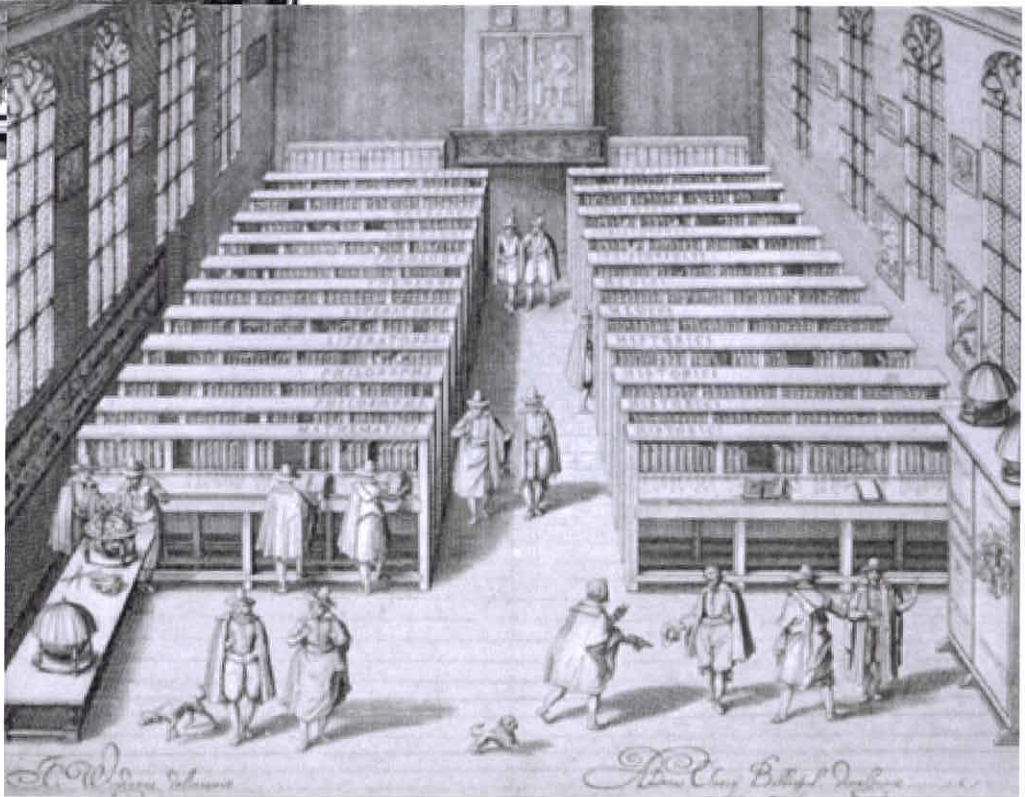
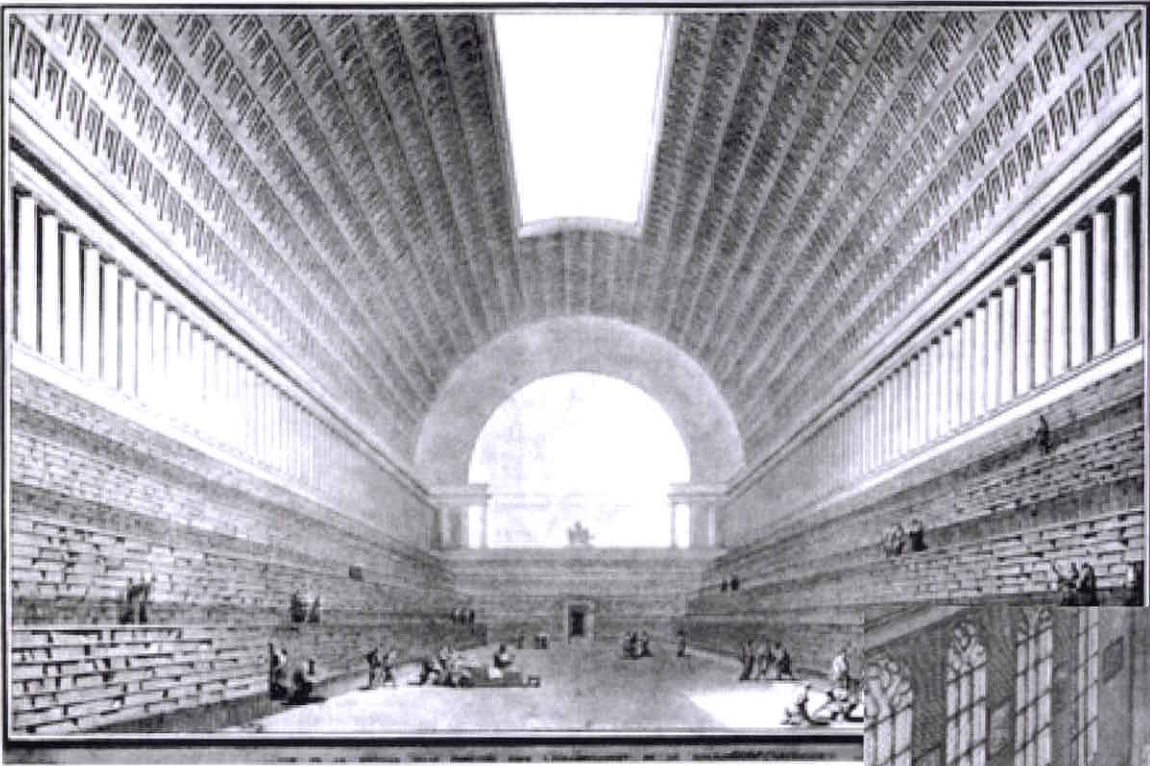

PROGRAM

If the building is to successfully celebrate scholarship over the mere acquisition of knowledge, its form must transcend strict functionalism as the basis for design, stressing the concept of books rather than the books themselves. This requires an examination of the library as a cultural icon, the center of community and a place to celebrate learning. This synthesis of people and forms of media must be more than a functional container for books. However, despite the library's key principle of free access to information for all in society, modern technology has created an IT underclass as serious as the problems of literacy. It is likewise not a mechanical container for digital equipment.



PROGRAM

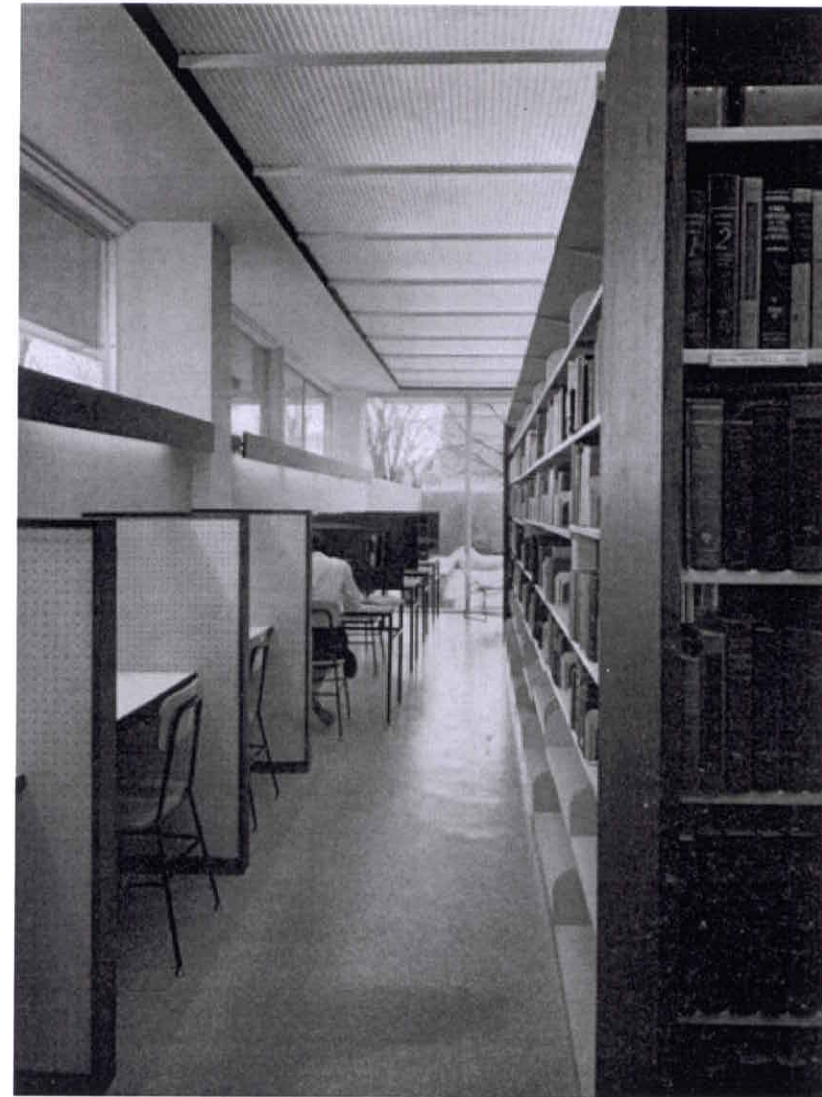

SITE



PROGRAM

GESAMTKUNDSWEEK

DESIGN

EXPERIENCING

EXPLORING

ILLUMINATION

CONCLUSION

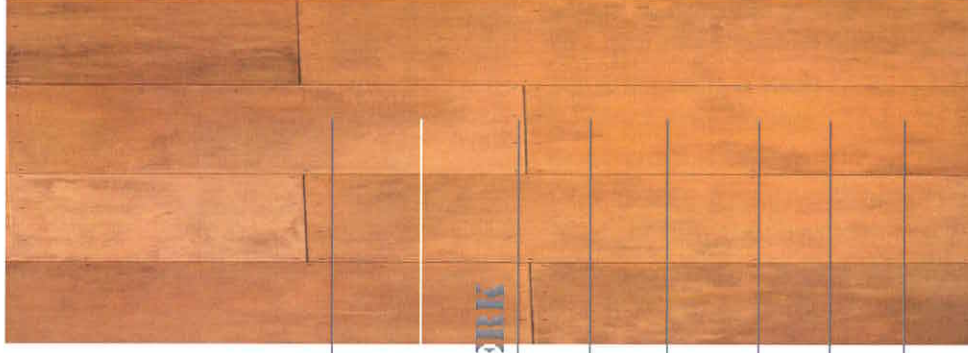

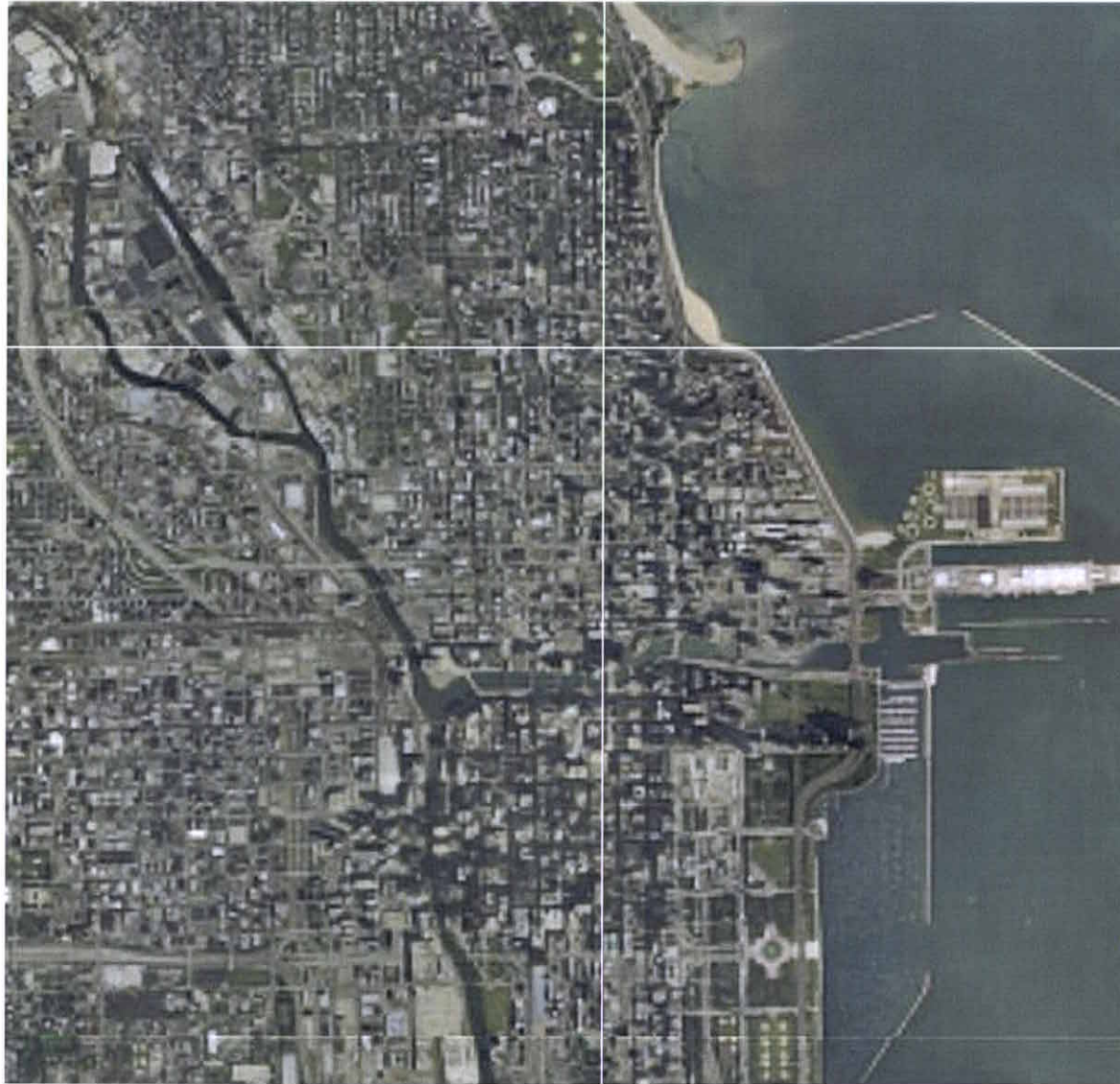

The site selected for this study is located in the heart of Cabrini Green in Chicago; an area with a long history of neglect and abuse. The eponymous community is one where this investigation is particularly poignant. It's social dynamic is one where the traditional understanding of a library as definition and representation as humanity is desperately needed as a provider of services to a mix of haves and have-nots. The services must look beyond traditional literacy to computer literacy; nimble access to digital words, images and sounds. Elements that are increasingly critical to survival in today's world.

SITE

SITE



Transportation

SITE



Civic Buildings

SITE



Parks



SITE

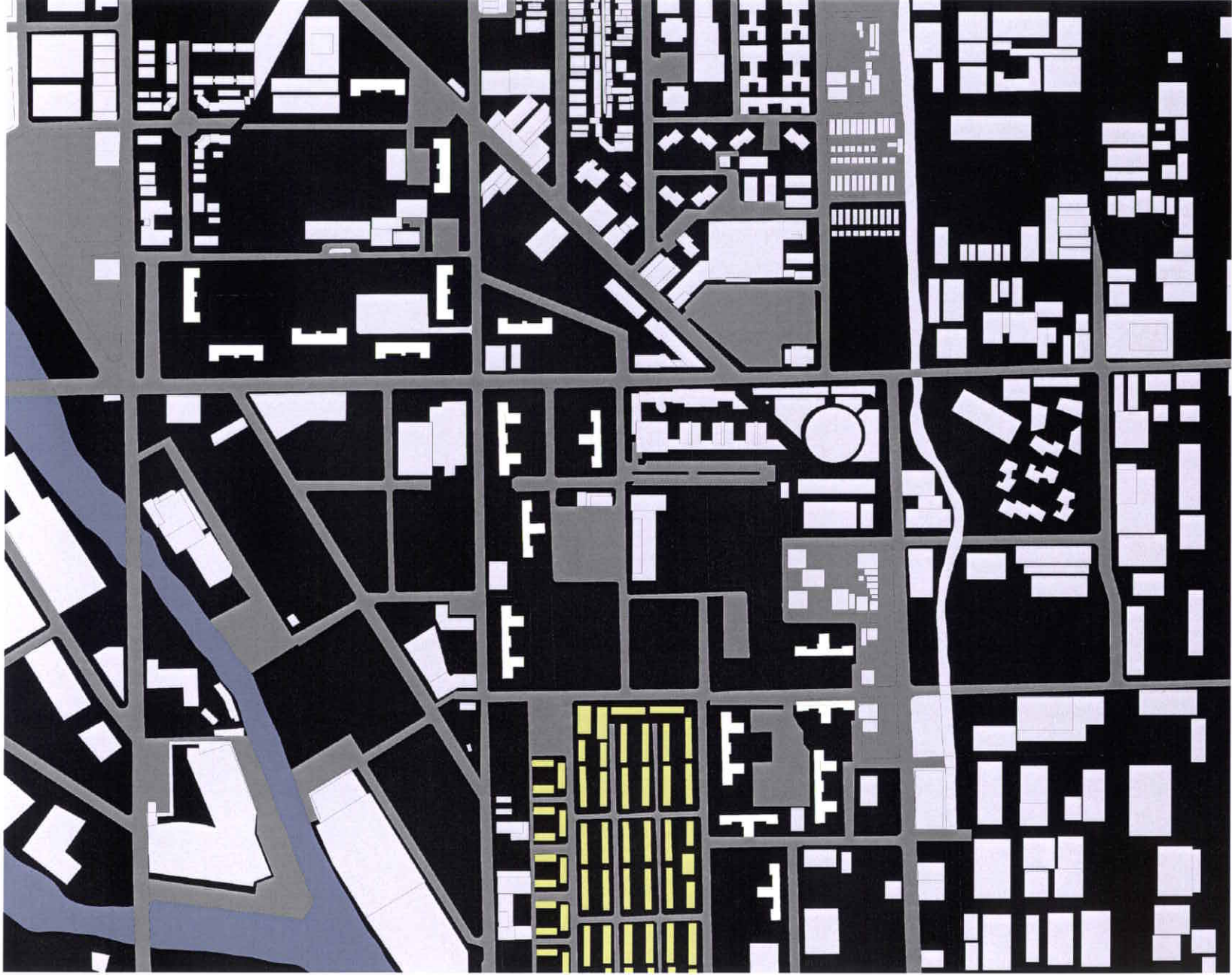

SITE

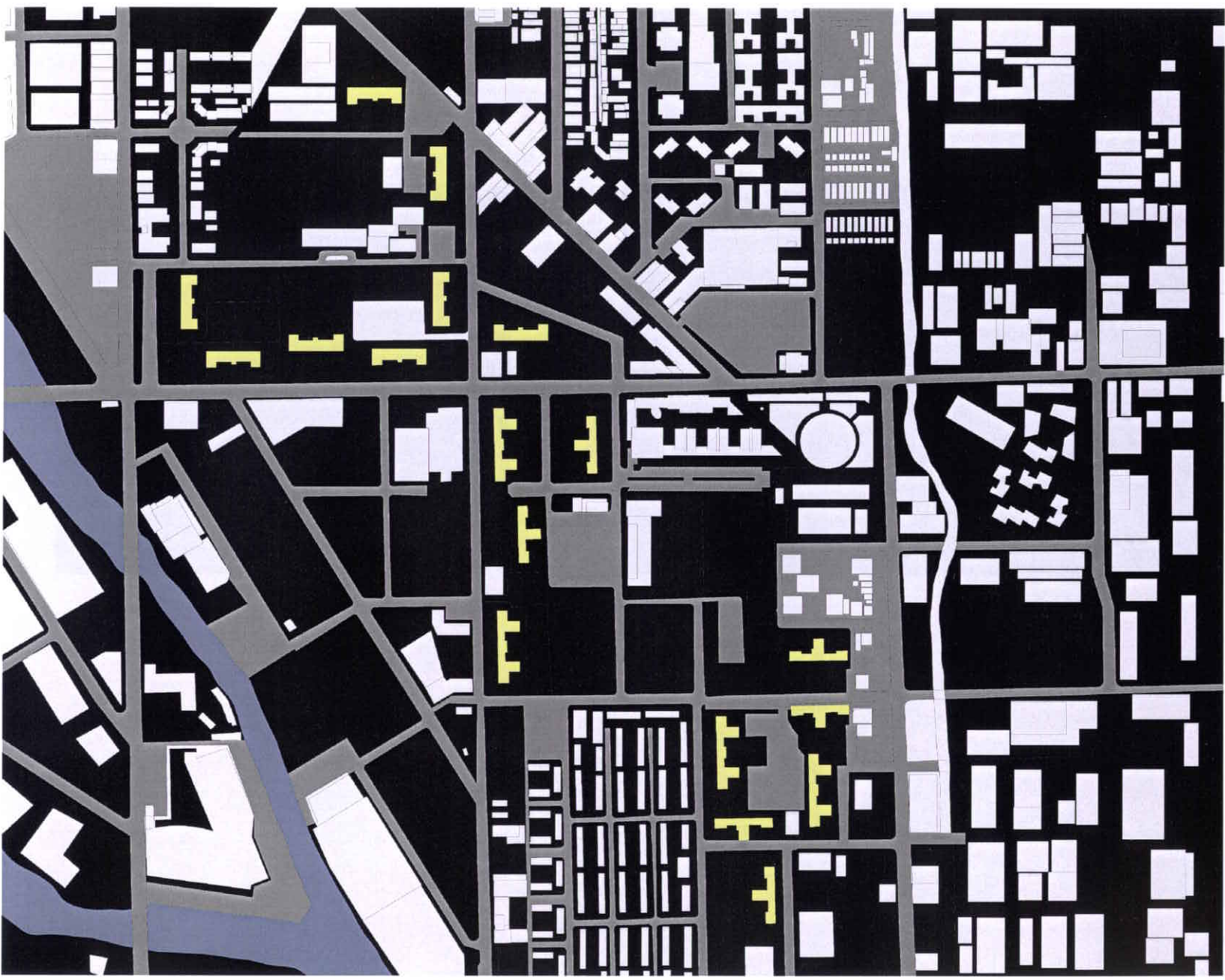

SITE

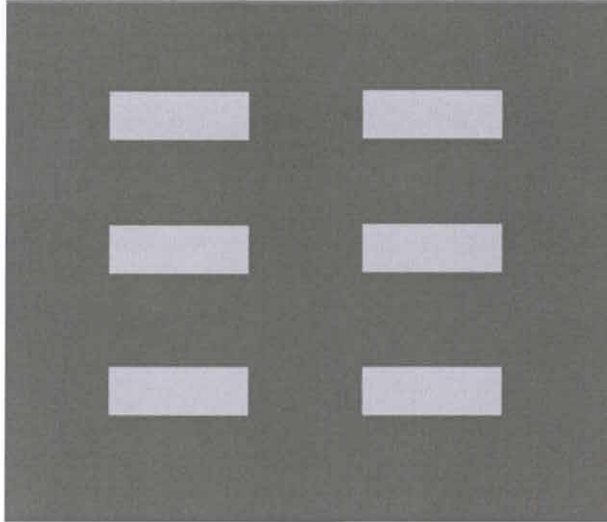

BUILDINGS SITED WITHIN A FIELD

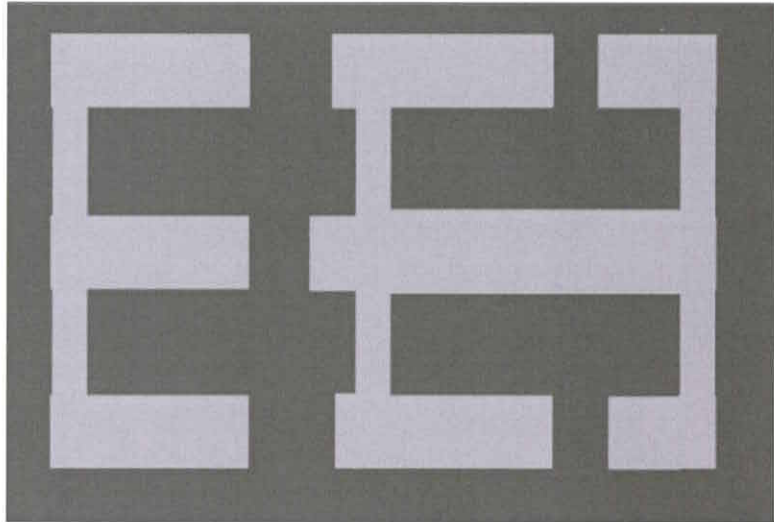

BUILDINGS SITED AS A MEANS OF CREATING WELL DEFINED COURTYARDS

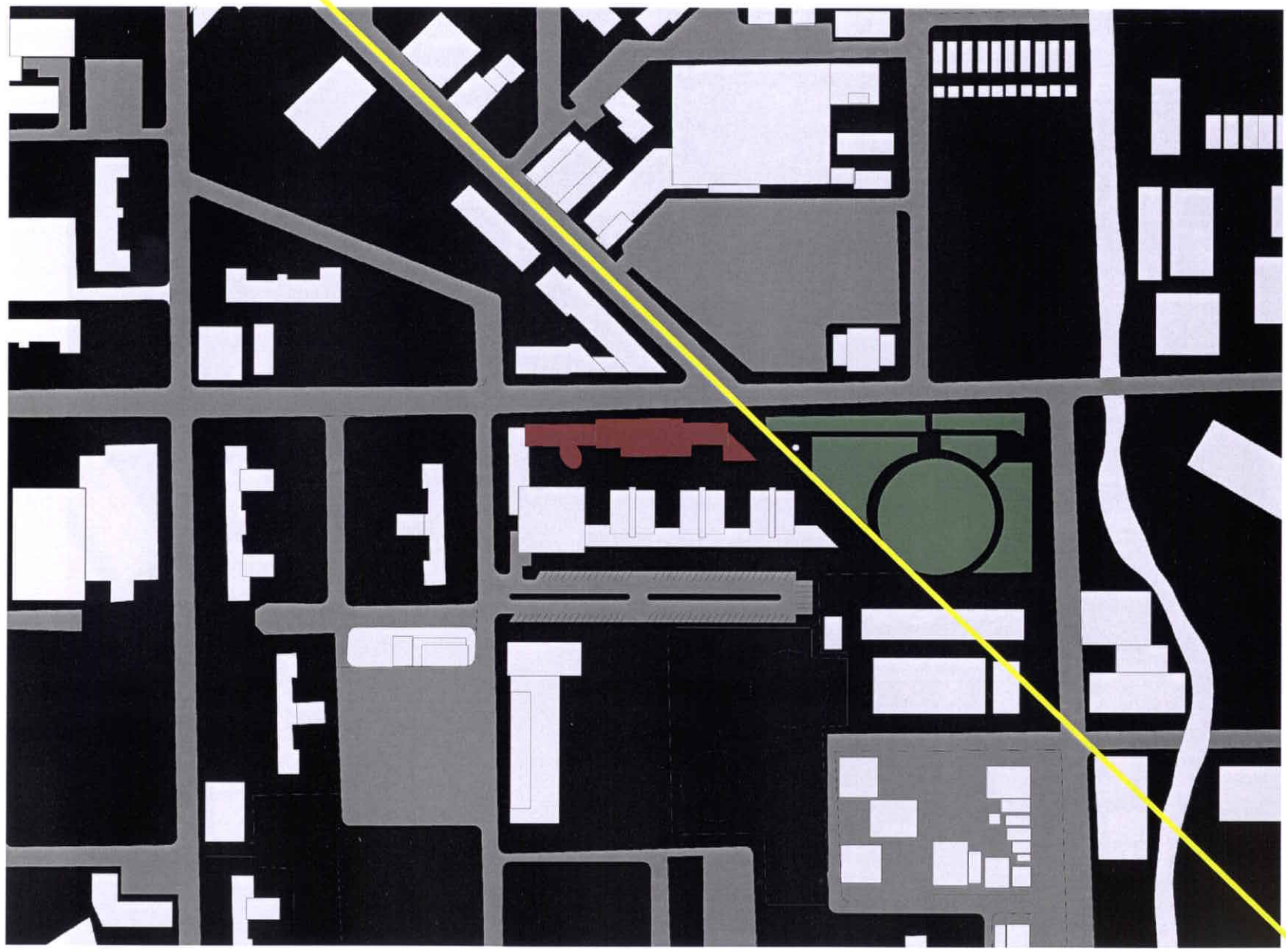

SITE

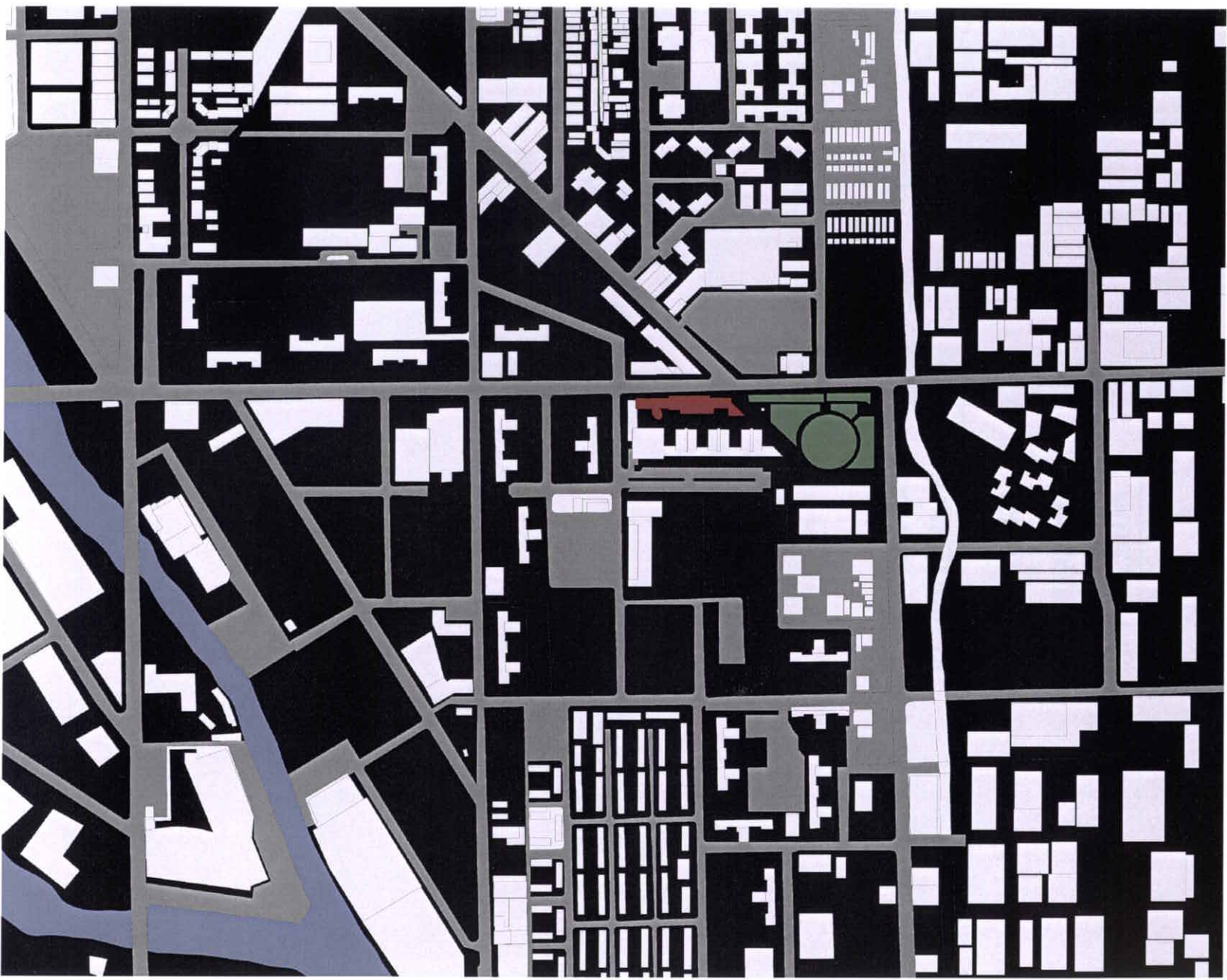

SITE

GESAMT'KUNSTWERK



PROGRAM

SITE

DESIGN

EXPERIENCING

EXPLORING

ILLUMINATION

CONCLUSION

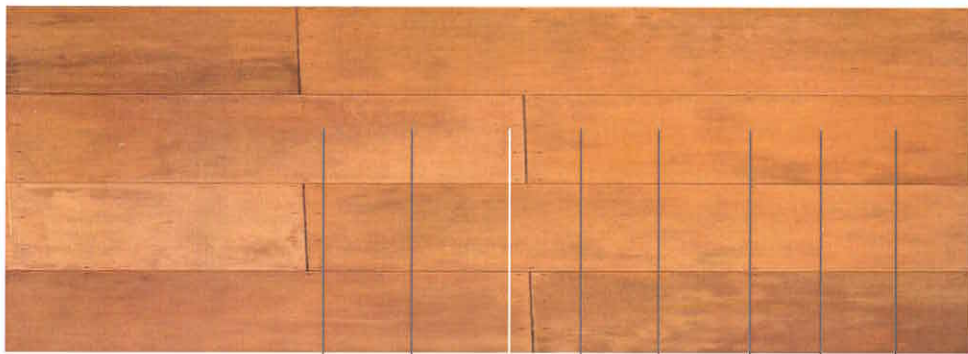



GESAMTKUNSTWERK



My resolution to the issues proposed by program and site took a cue from the ideology of Gesamtkunstwerk, a term coined by Richard Wagner to describe a method of creation which combines all the individual arts to express in seamless integrity an overriding idea through a single medium of artistic expression.



GESAMTKUNSTWERK





Applied to modern architecture, the philosophy of Gesamtkunstwerk describes the totalizing effect on human consciousness achieved through the synthesis of essential components, including space, composition, procession, texture and light, into an organic whole. Gesamtkunstwerk found physical form and voice through the architect Kluver who constructed a pavilion for the Osaka expo.

“The quality of the experience of the visitor should involve choice, responsibility, freedom and participation. The pavilion would not tell a story or guide the visitor through a didactic authoritarian experience. The visitor would be encouraged as an individual to explore the environment and compose his own experience.” –Billy Kluver

GESAMTKUNSTWERK

DESIGN

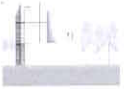
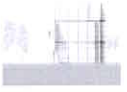

PROGRAM

SITE

GESAMTKUNSTWERK

EXPERIENCING

EXPLORING

ILLUMINATION

CONCLUSION

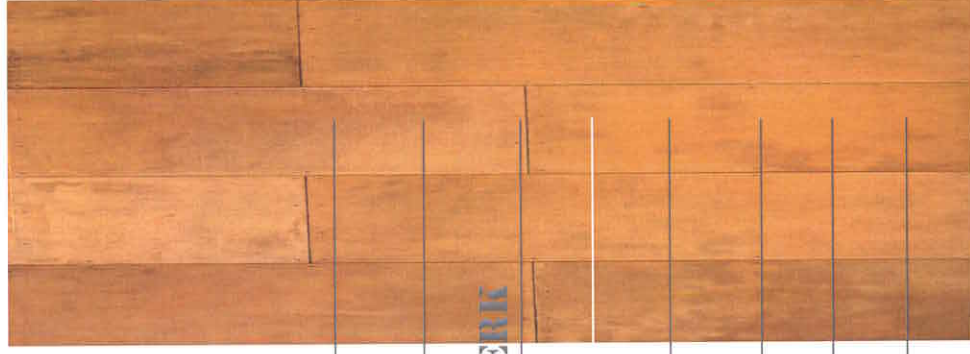

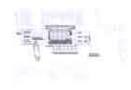
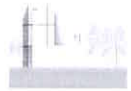

DESIGN

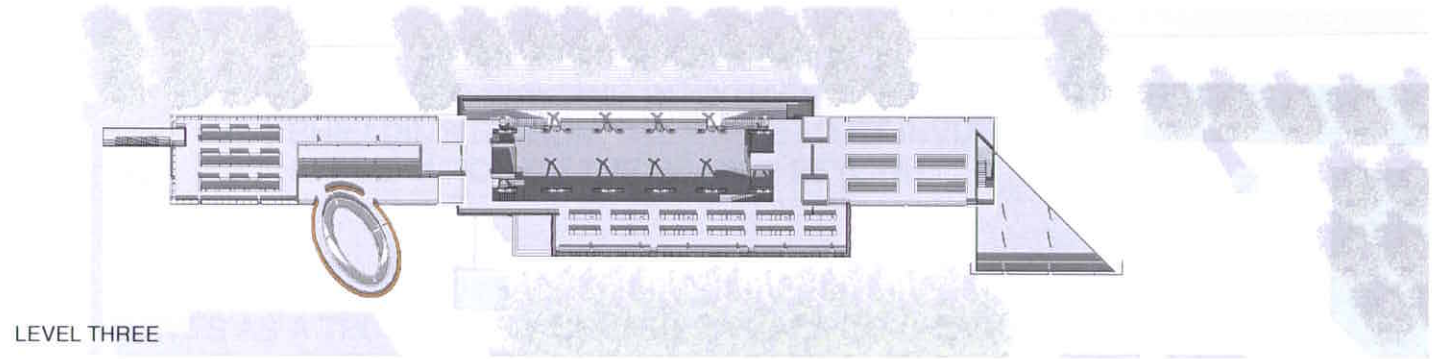

LEVEL THREE

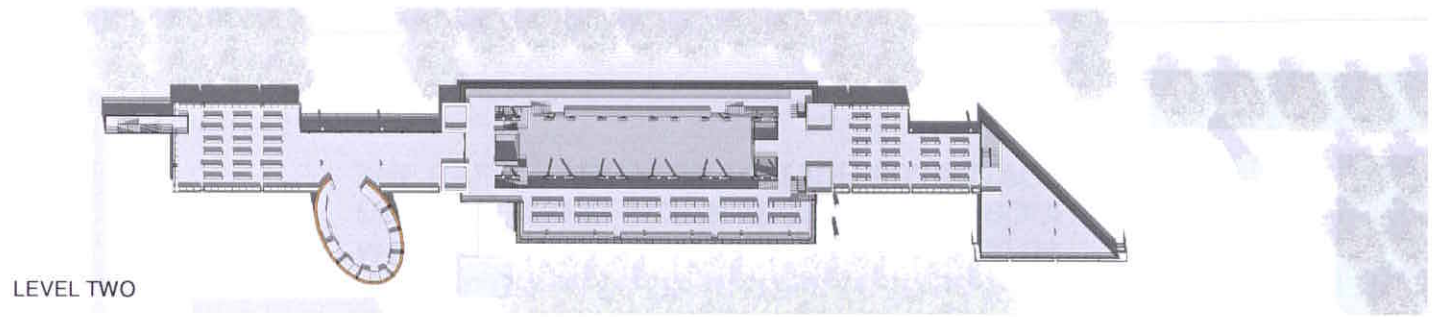

LEVEL TWO

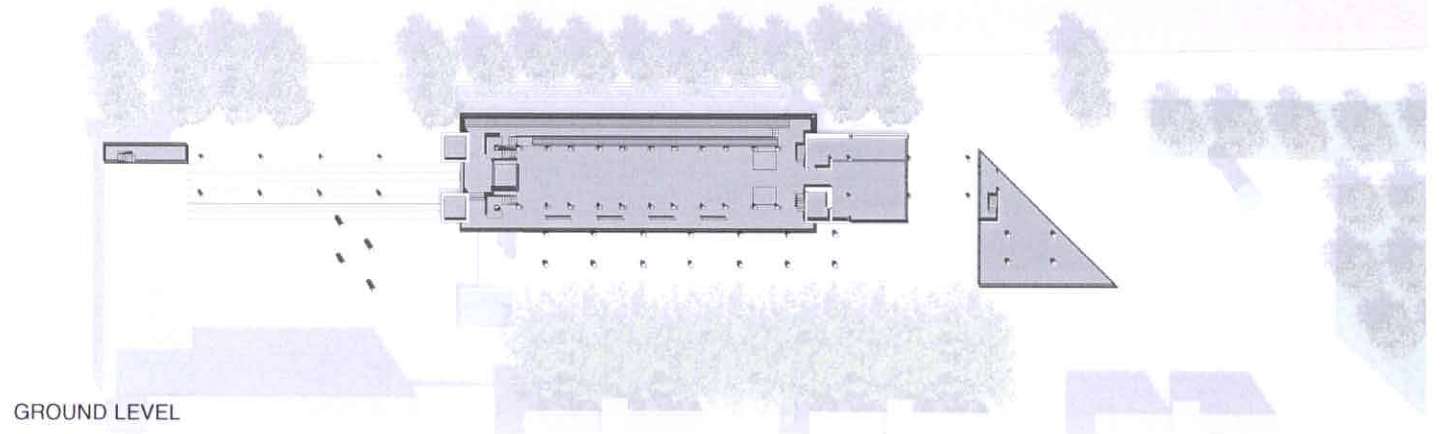

GROUND LEVEL

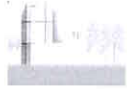

DESIGN

A SEIVE EFFECT IS CREATED BY TWO METHODS OF PASSING UNDER THE BUILDING INTO THE SOUTHERN COURTYARD, SHIELDING IT FROM THE STREET, YET INVITING EXPLORATION OF THE SPACES BEYOND.

THE LARGE CENTRAL SPACE SERVES AS A TECHNOLOGY CENTER, A PLACE TO CHECK EMAIL, SURF THE INTERNET, LOOK IN THE LIBRARY CATALOGUE AND SOCIALIZE WITH OTHERS. IT MORE INFORMAL NATURE SEEKS TO CREATE AN ATMOSPHERE MORE AKIN TO AN INTERNET CAFÉ THAN TRADITIONAL LIBRARY. LARGE EXPANSES OF GLASS INVITE THE FLANEUR TO WANDER INSIDE.

THE CAFE IS LOCATED TO TAKE ADVANTAGE OF THE MAJOR TRAFFIC INTERSECTION OF CLYBOURN AS WELL AS THE SOUTHERN COURTYARD WITH OPPORTUNITIES FOR OUTDOOR SEATING.

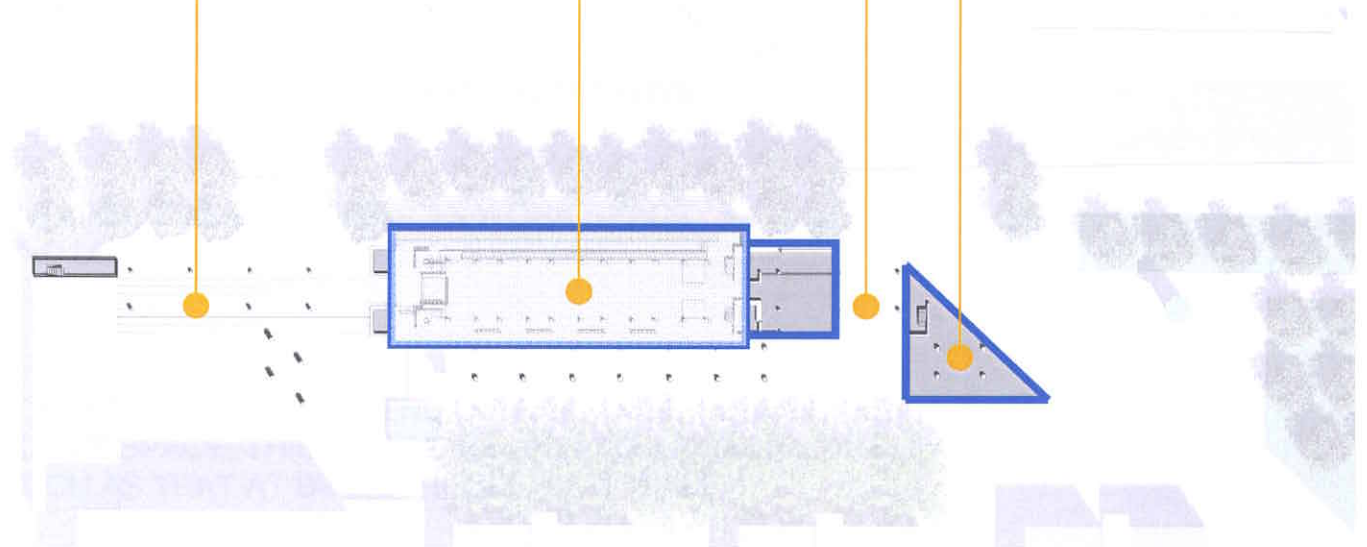



THERE IS A SEPARATE SPACE FOR THE CHILDRENS SECTION. THE DISTINCTIVE ARCHITECTURE SIGNALS ITS IMPORTANCE. THIS SIZE OF THE SPACE ALLOWS FOR LARGER GATHERINGS FOR STORY HOUR AND THE UNIQUE WALL POCHÉ PROVIDES A UNIQUE READING EXPERIENCE FOR DEVELOPING MINDS.

THE NORTH, MORE PUBLIC, FAÇADE IS LINED WITH COMPUTER TERMINALS

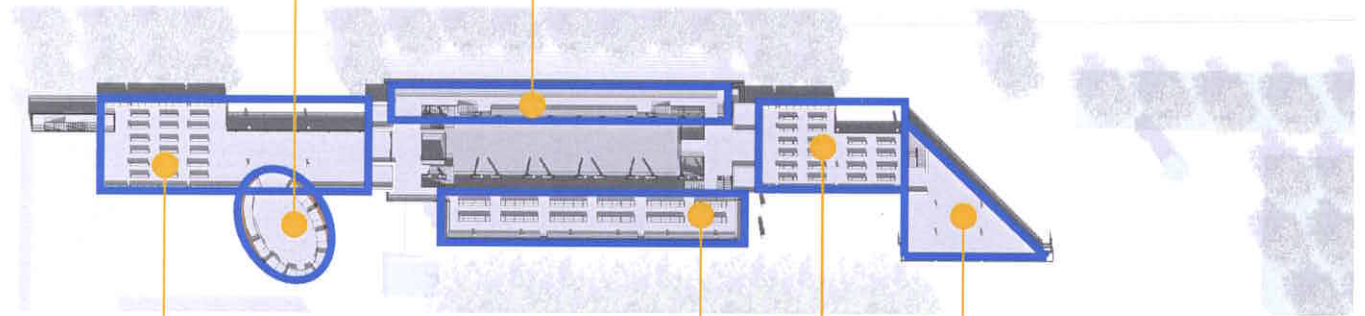

THERE ARE STACKS ON BOTH THE EAST AND WEST ENDS OF THE BUILDING. BOTH SPACES EMPLOY CARRELS THAT ARE FED BY LIGHT FROM ABOVE

THE SOUTH FAÇADE CONTAINS STACKS AS WELL AS WORK SPACE THAT LINES THE WALL AND LOOKS OUT INTO THE COURTYARD.

A DOUBLE HEIGHT SPACE ON THE EAST END OF THE BUILDING CREATES YET A FOURTH DISTINCTIVE SPACE, THIS ONE MORE AKIN TO A TRADITIONAL READING ROOM SUCH AS THAT AT BIBLIOTHEQUE NATIONALE.



DESIGN

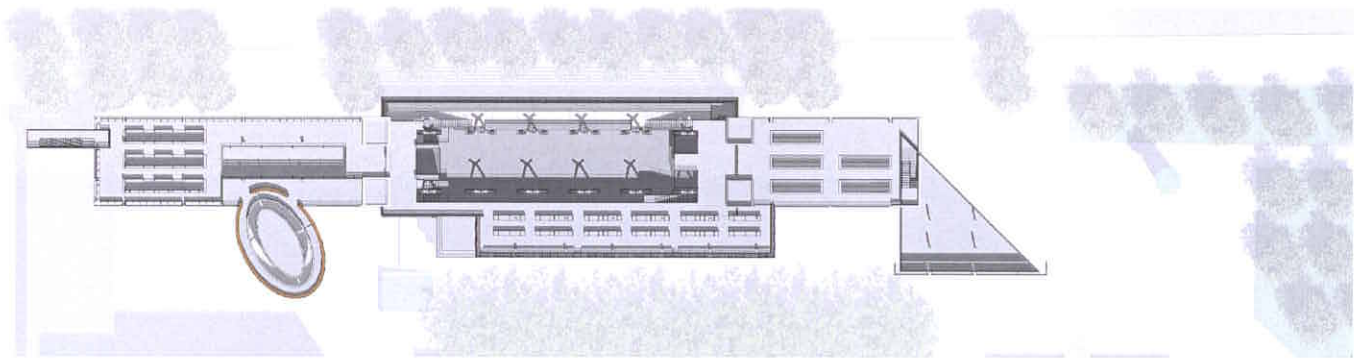



Structure

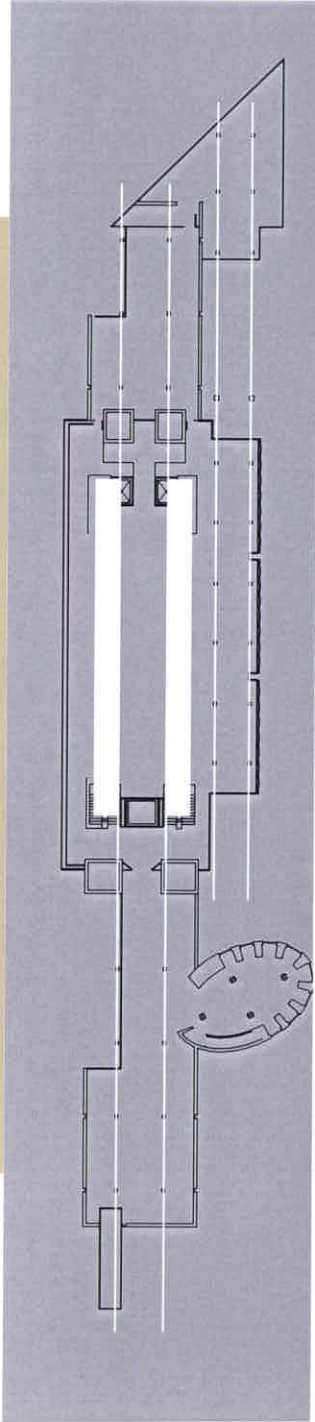
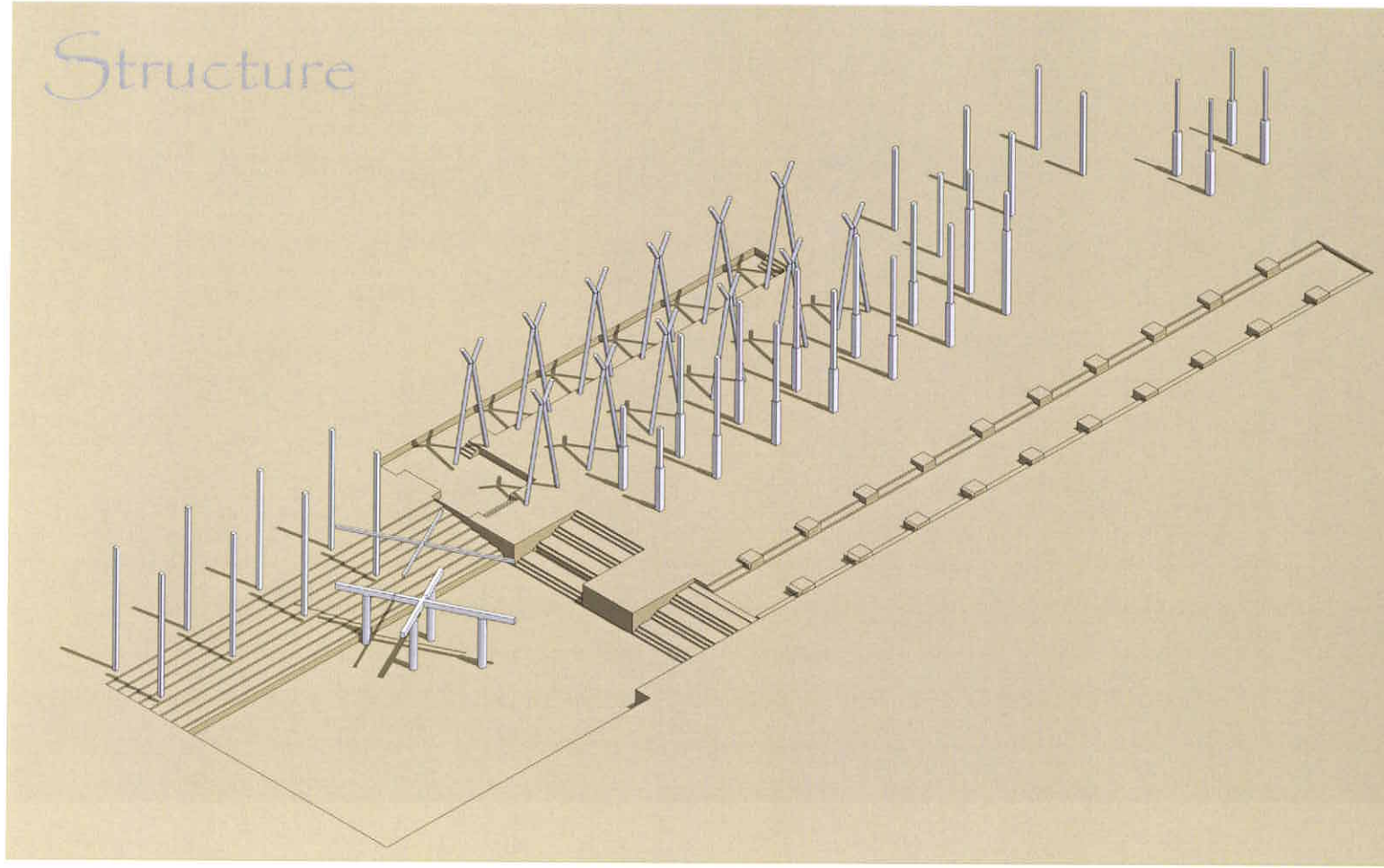

DESIGN

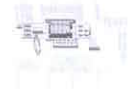
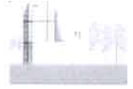

Stacks

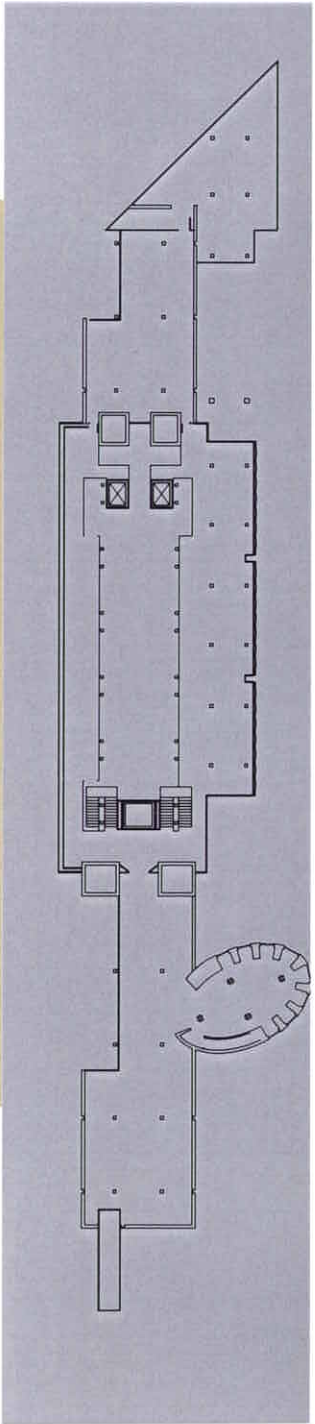
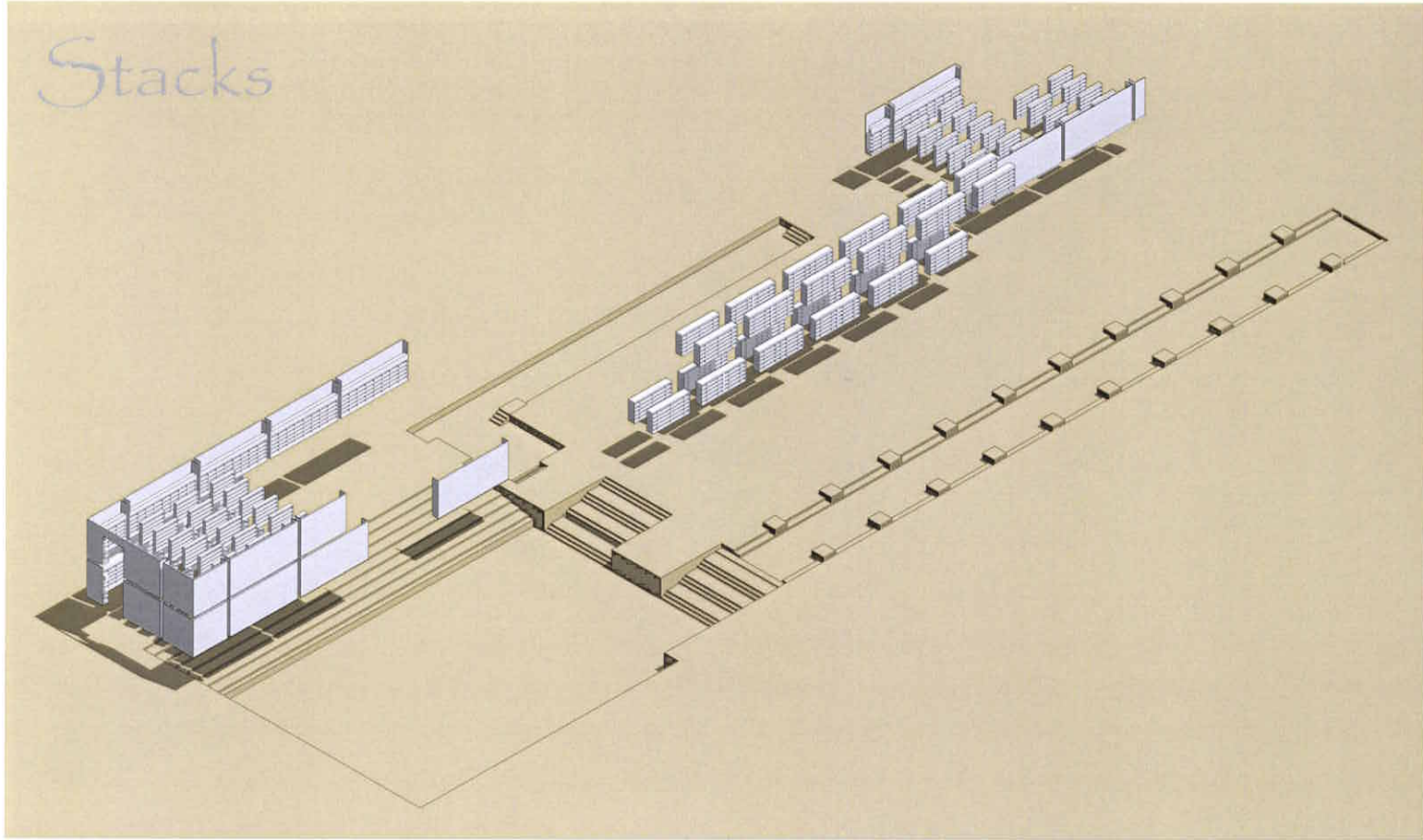

DESIGN



Envelope-Void

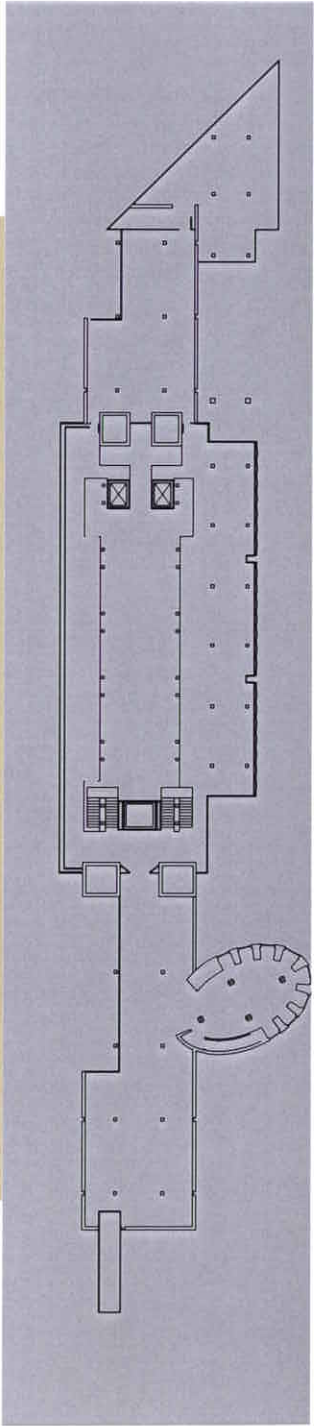
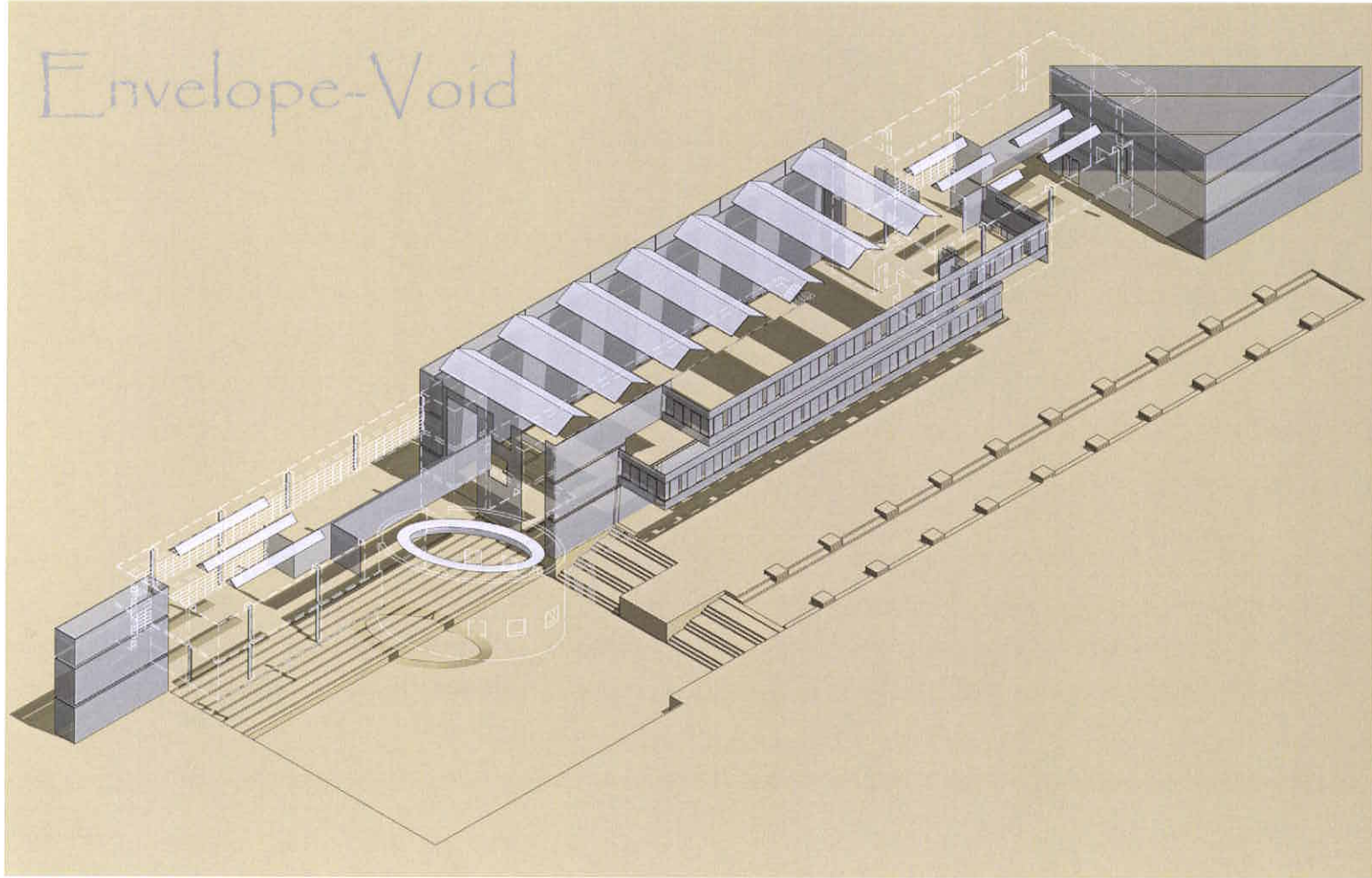

DESIGN



Envelope-Solid

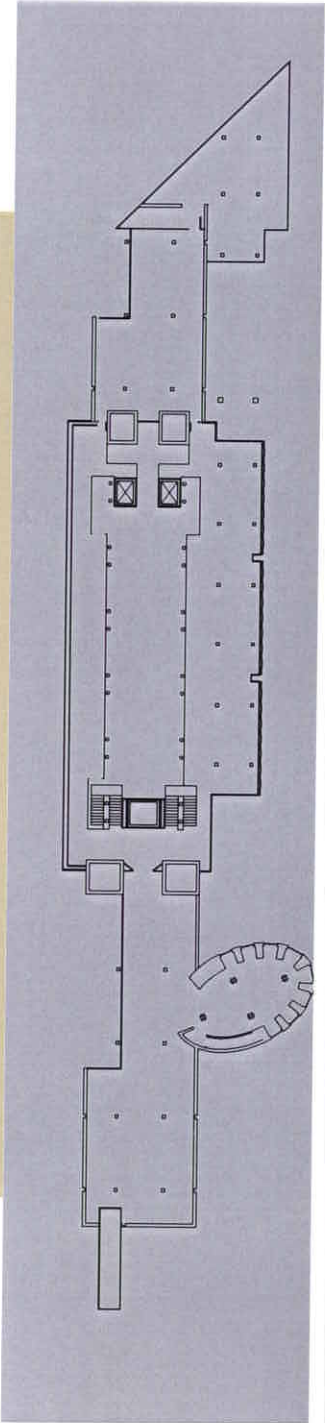
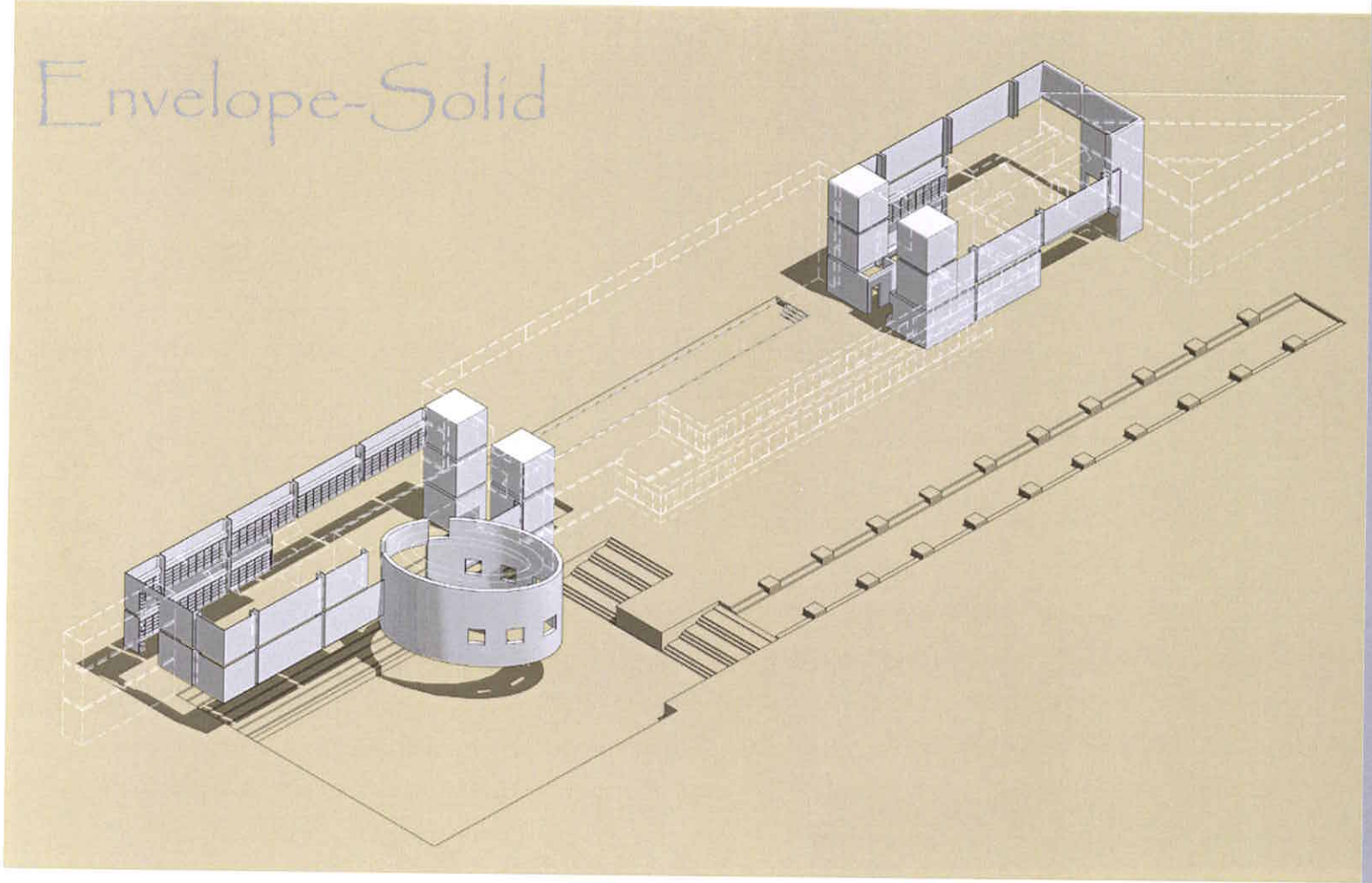

DESIGN

Connective Tissue

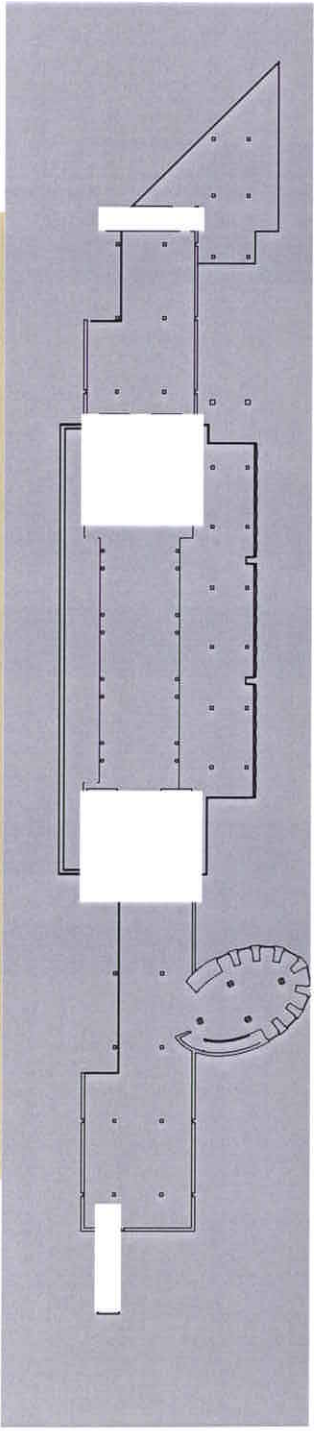
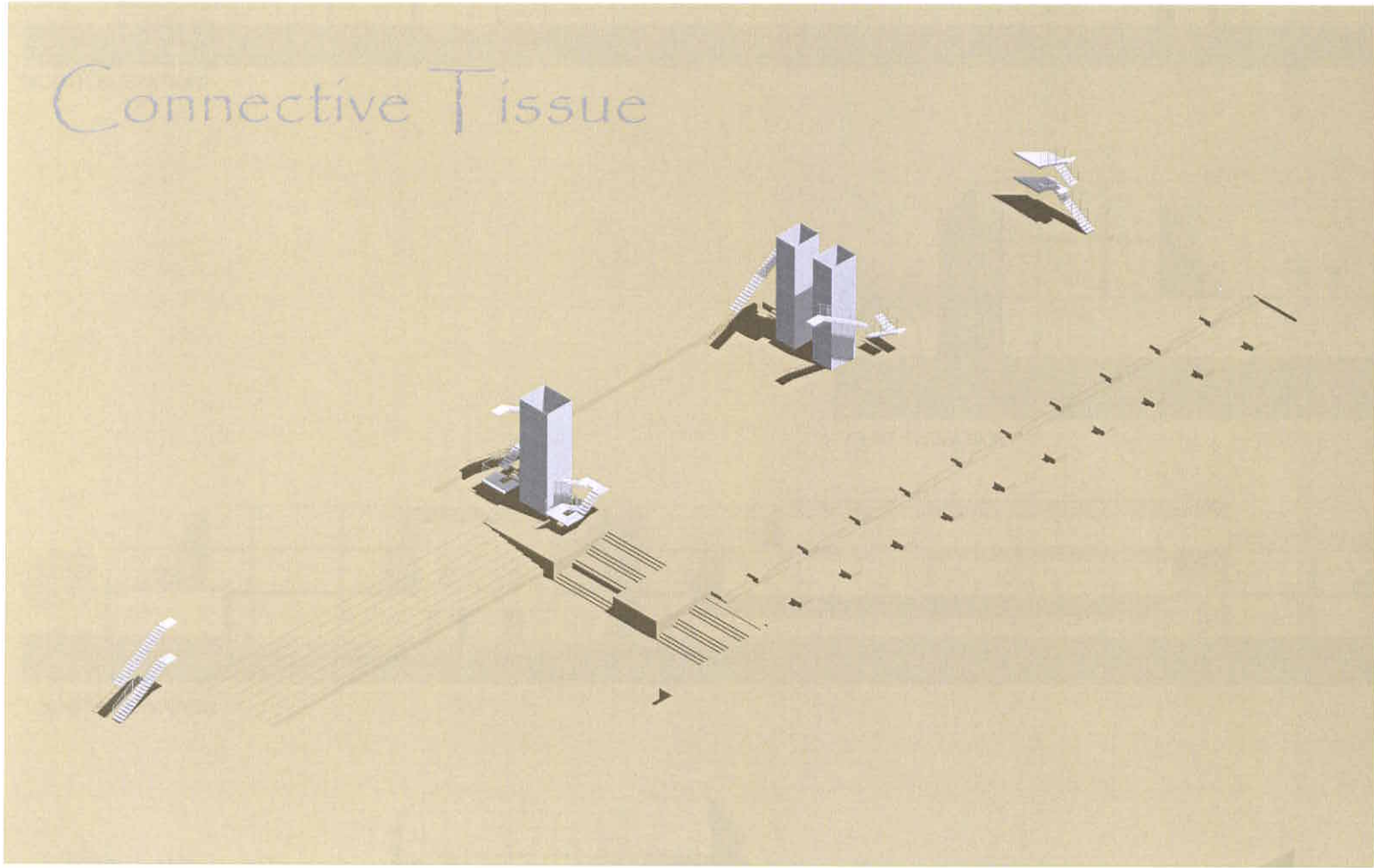

DESIGN

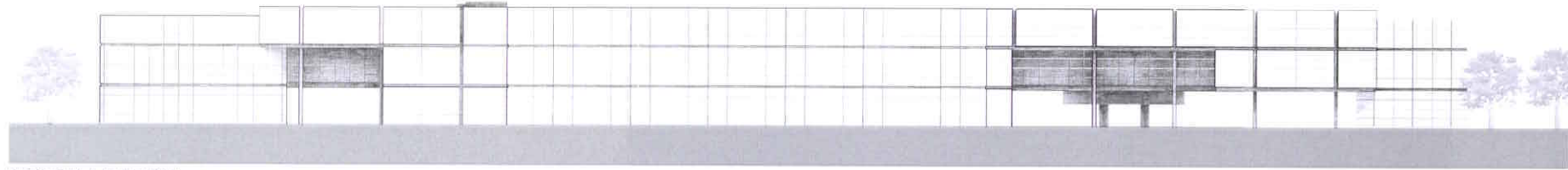
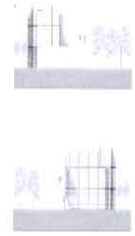

NORTH ELEVATION

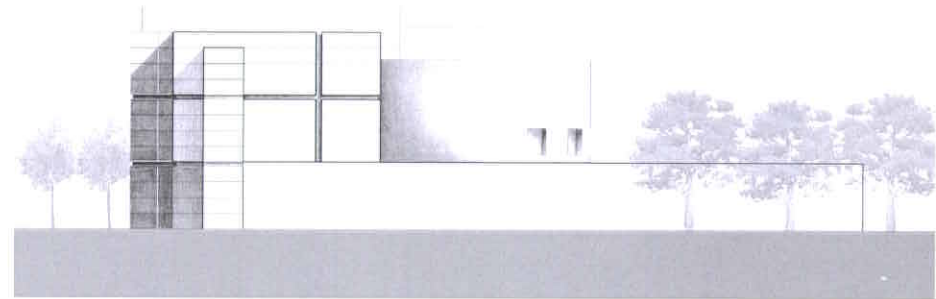

WEST ELEVATION

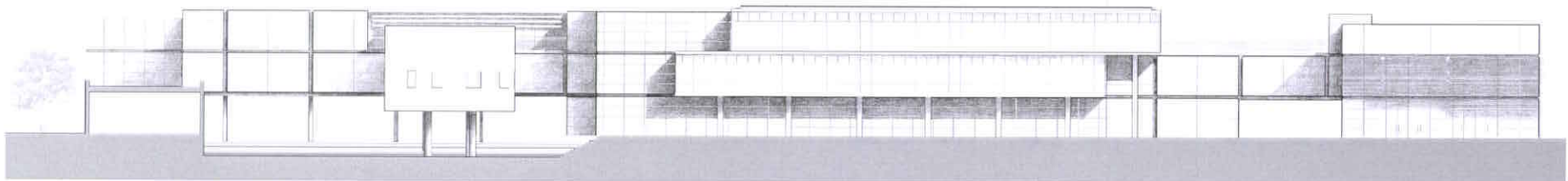

SOUTH ELEVATION

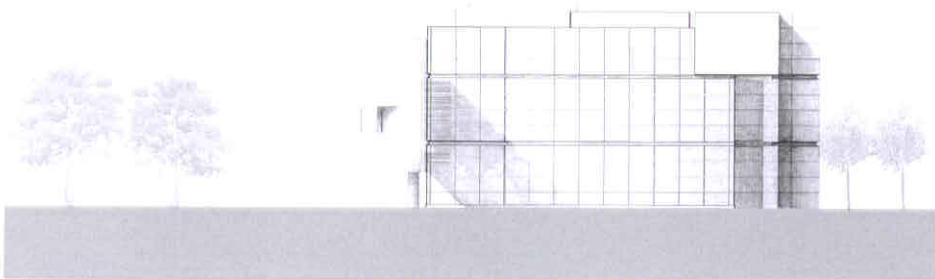

EAST ELEVATION

DESIGN

EXPERIENCING

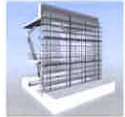

PROGRAM

SITE

GESAMTKUNSTWERK

DESIGN

EXPLORING

ILLUMINATION

CONCLUSION

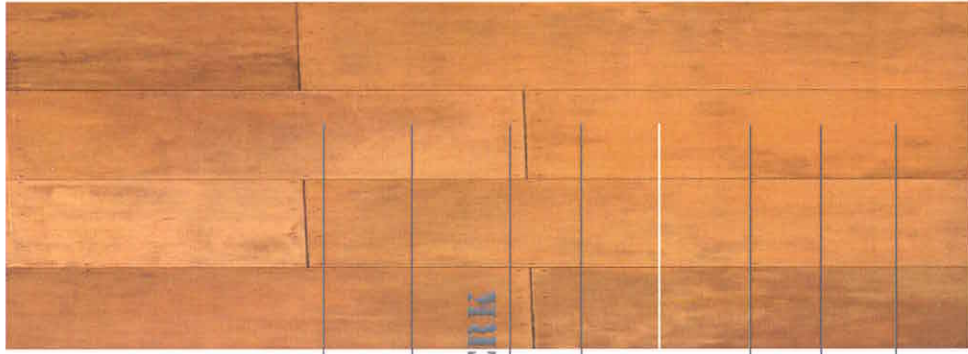

EXPERIENCING

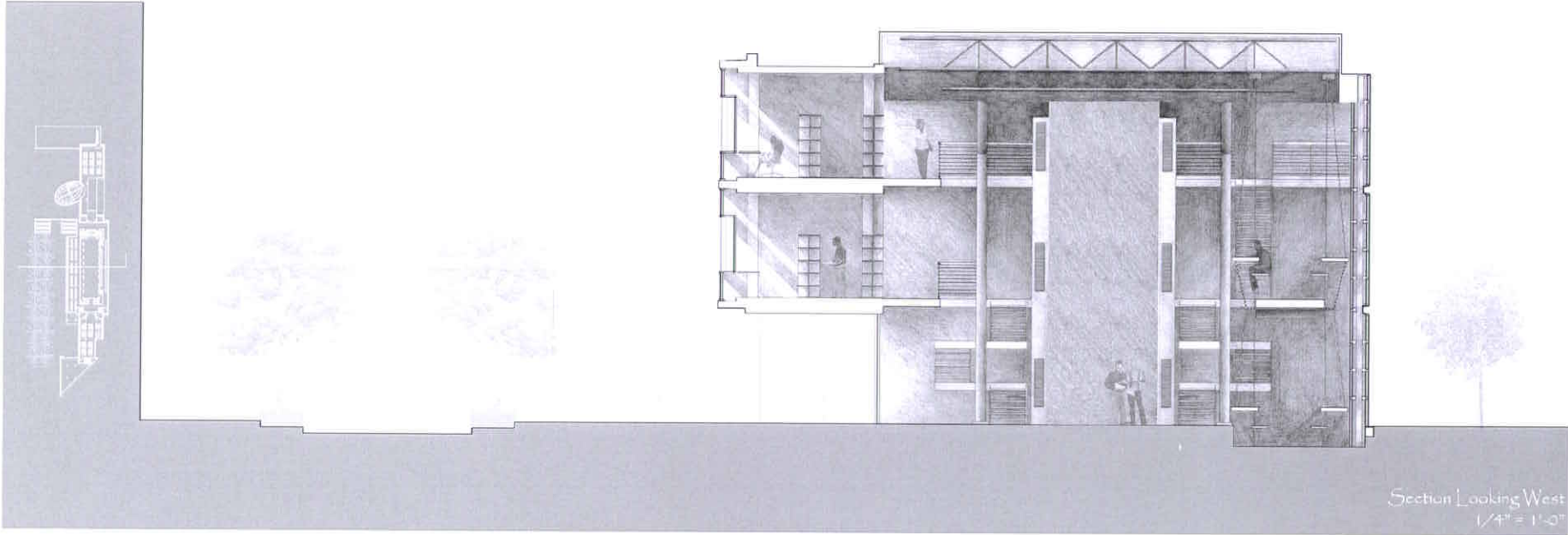

Section Looking West
1/4" = 1'-0"

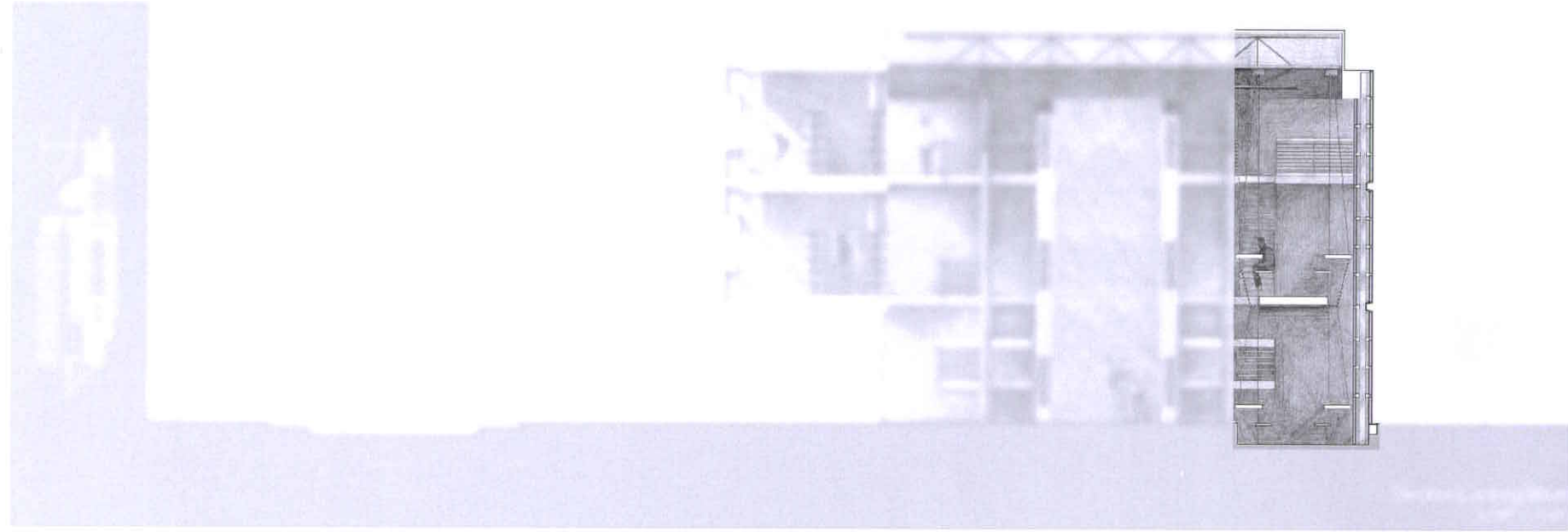
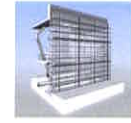

EXPERIENCING

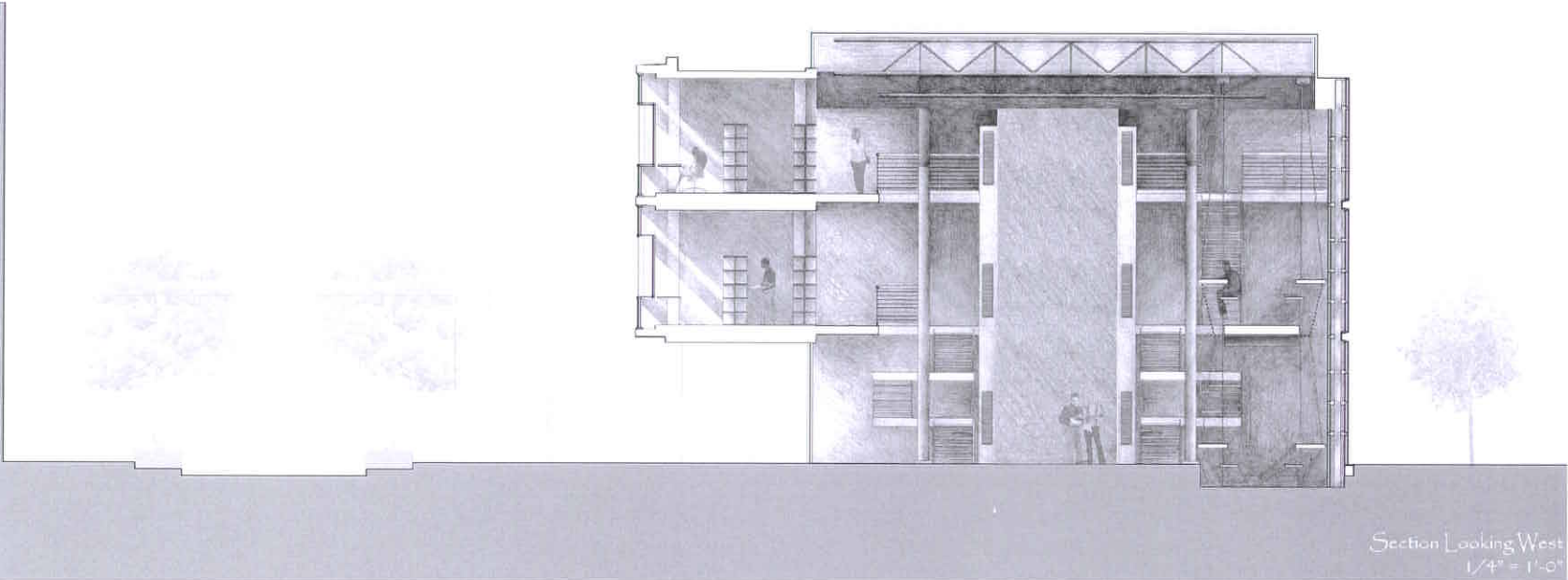
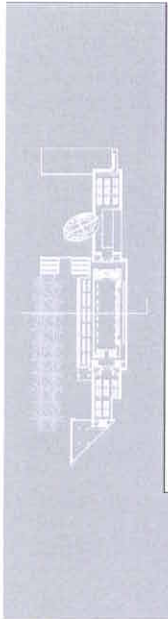
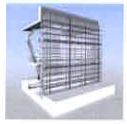

Section Looking West
1/4" = 1'-0"

EXPERIENCING

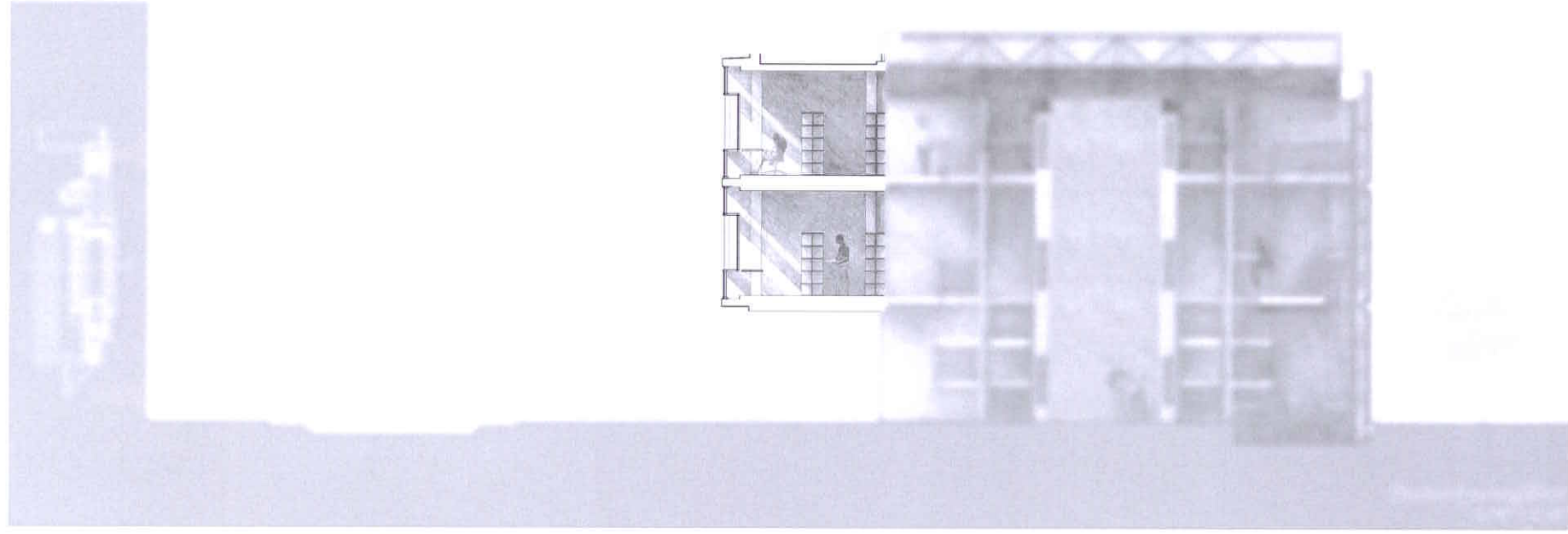
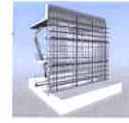

EXPERIENCING

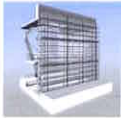

EXPERIENCING

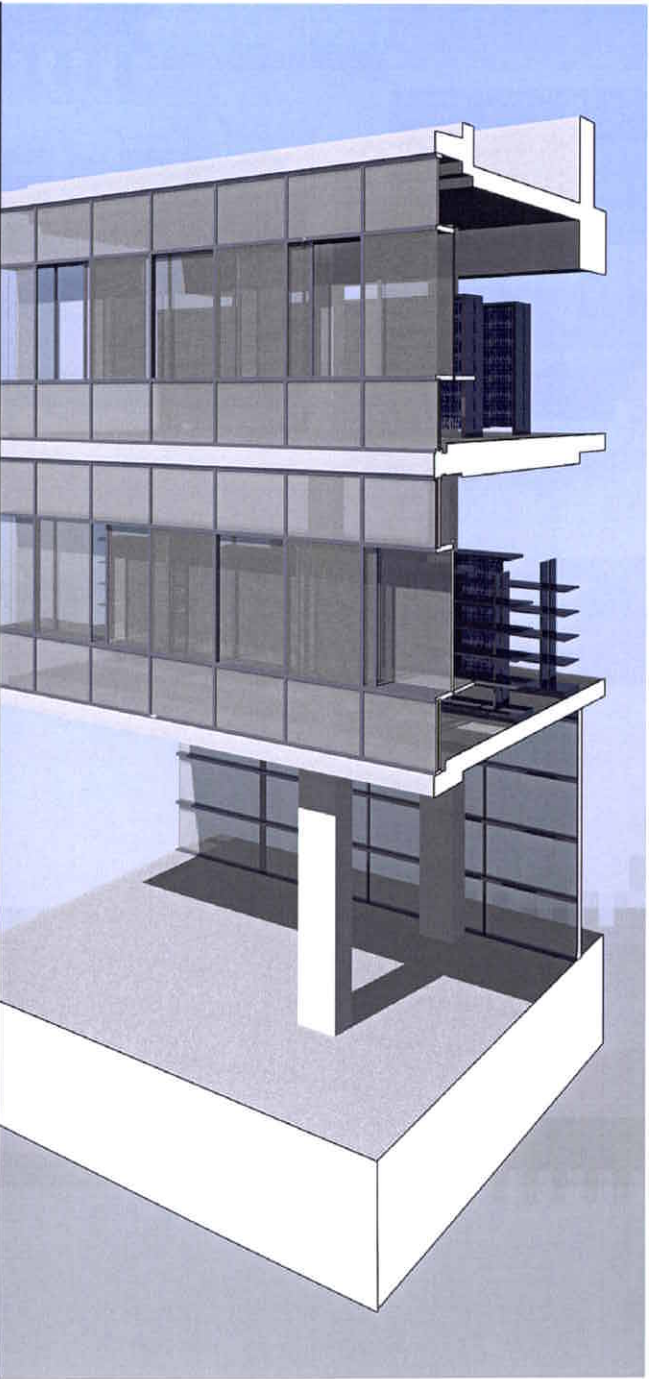
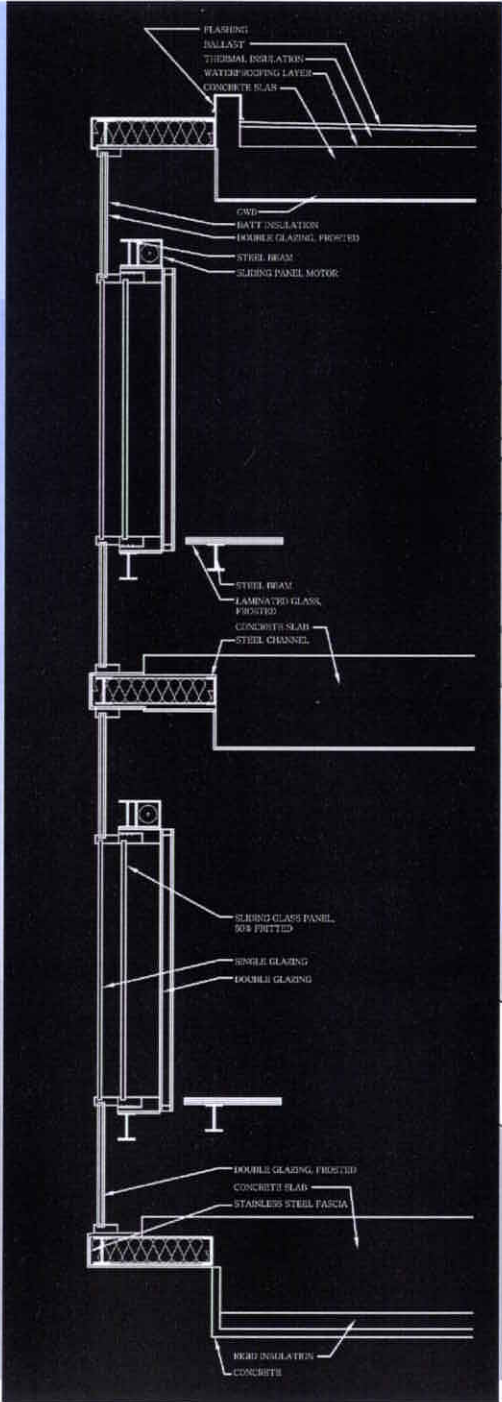
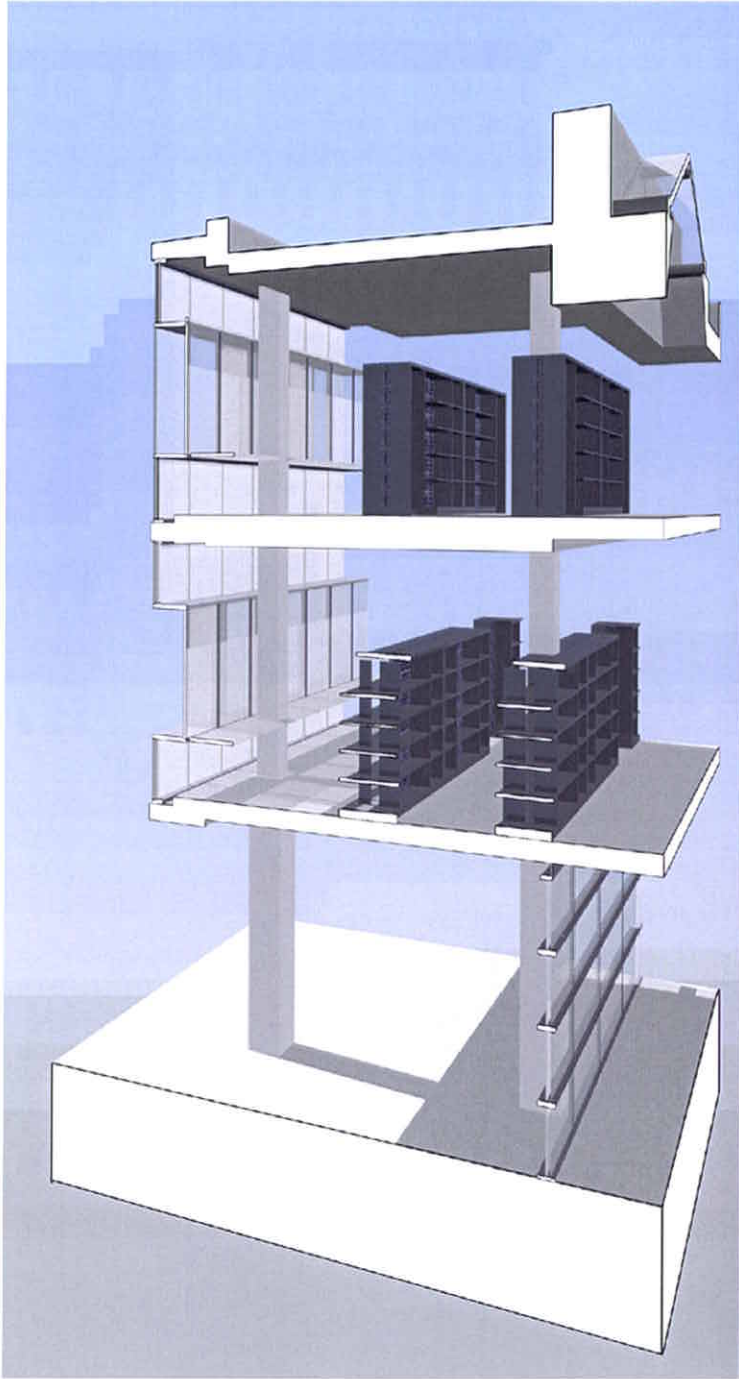

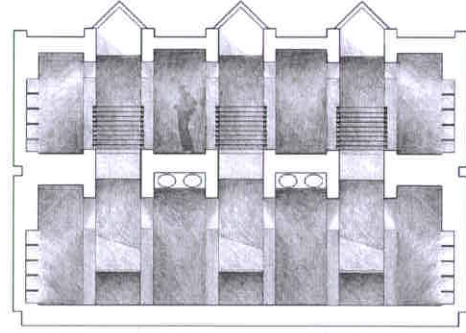
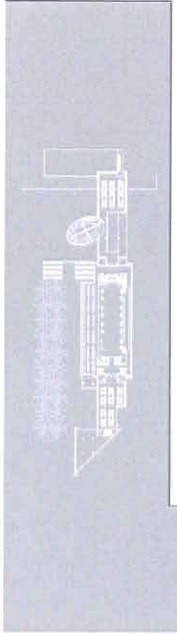
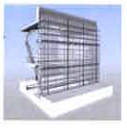

Section Looking West
1/4" = 1'-0"

EXPERIENCING

EXPERIENCING

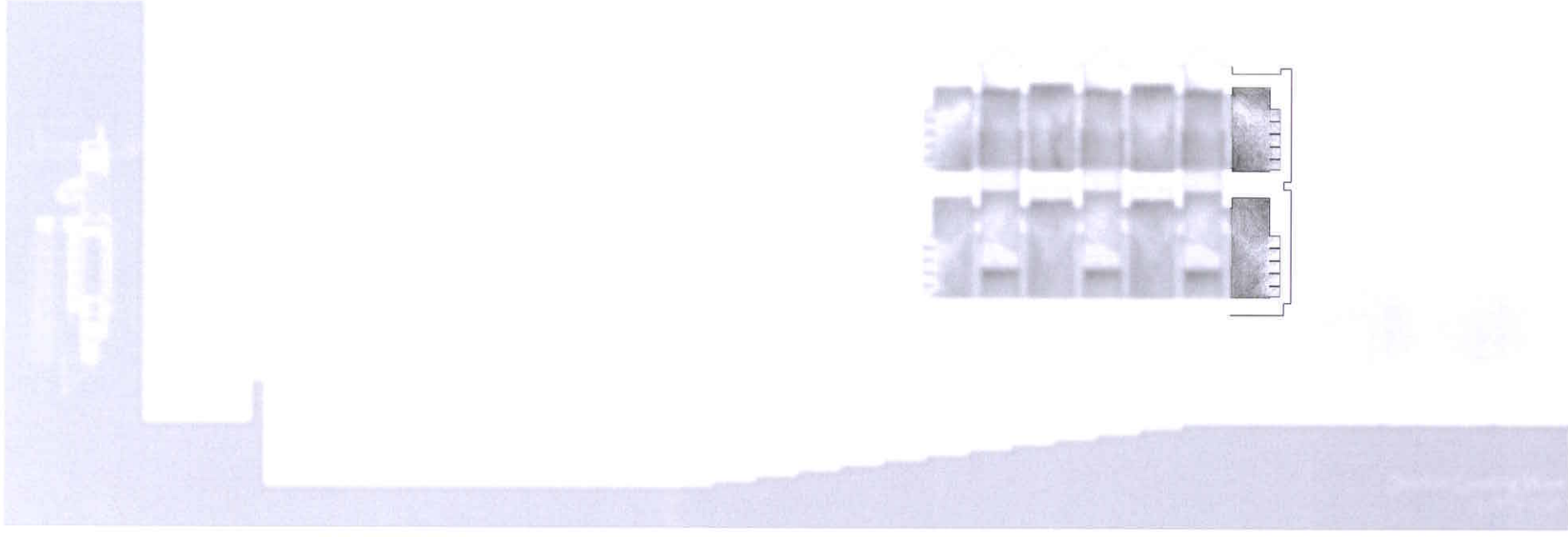
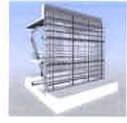



EXPERIENCING

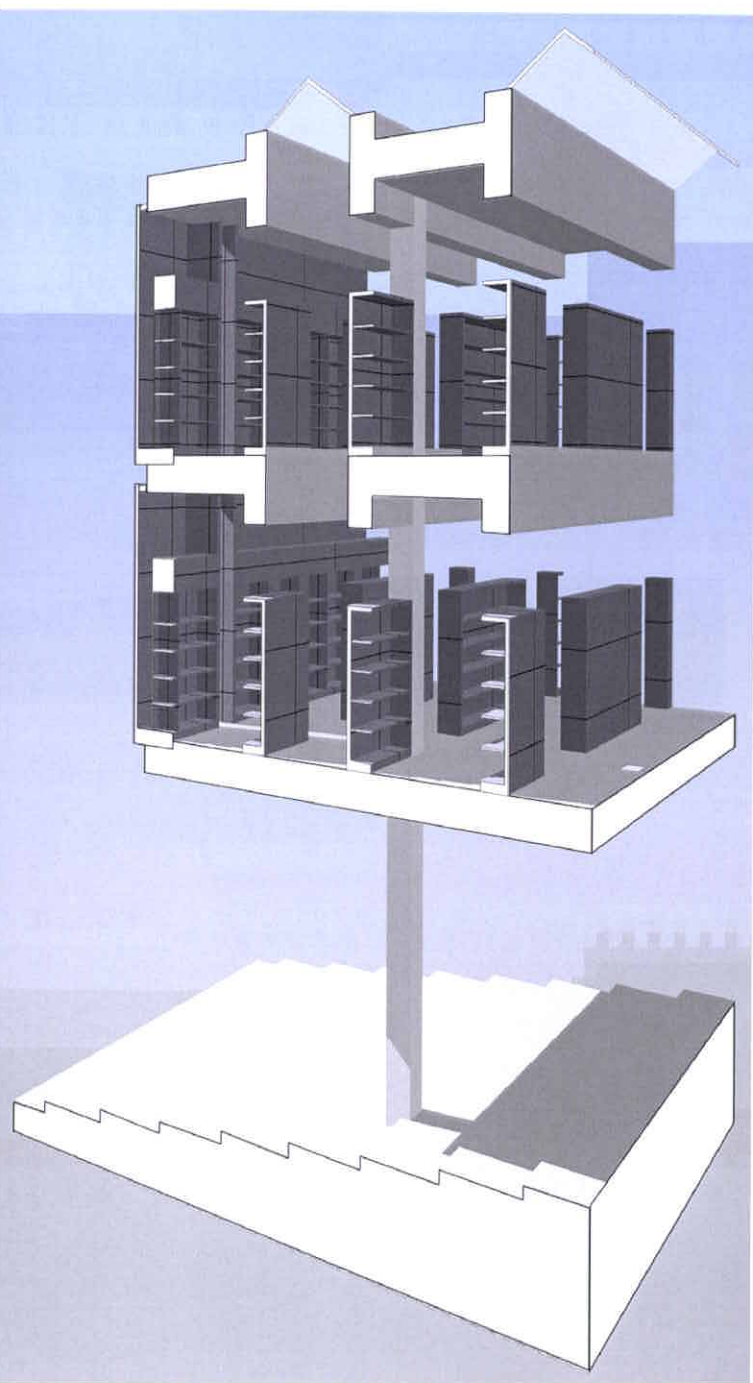
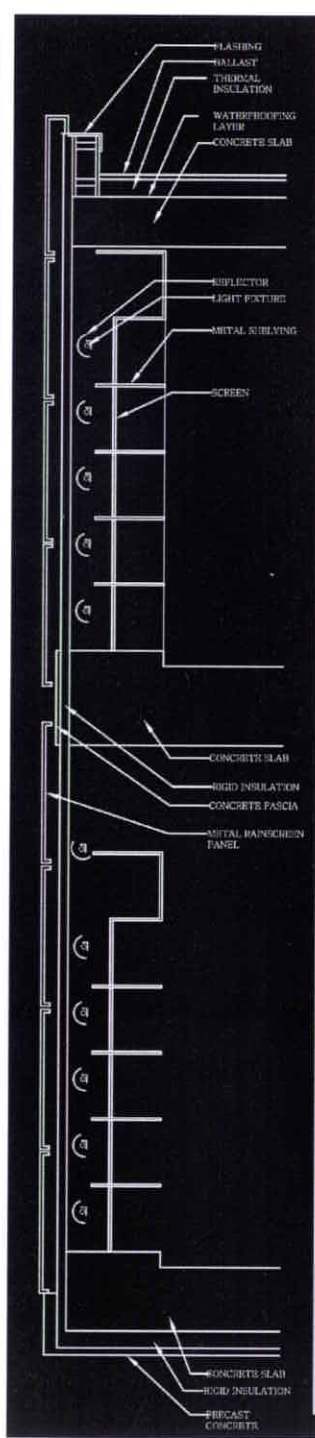
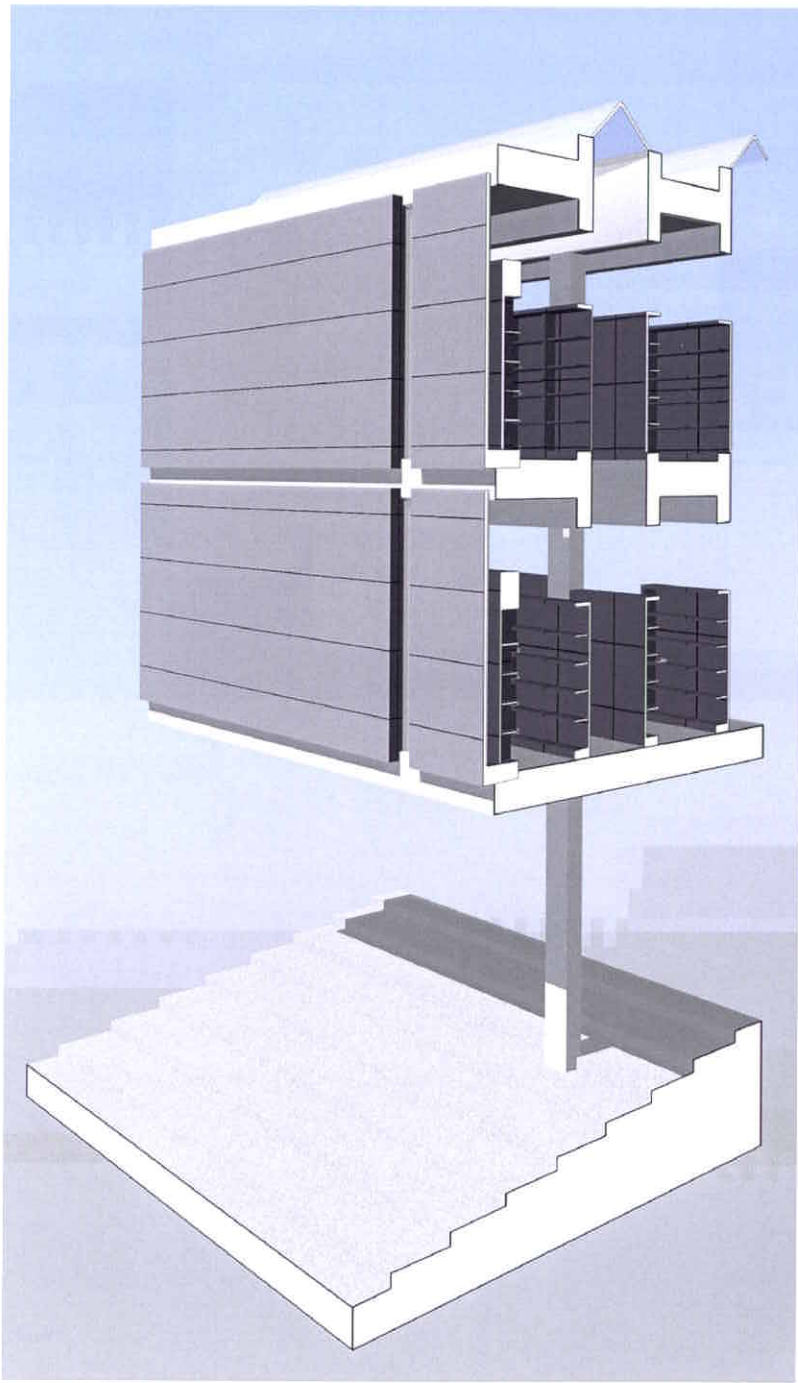

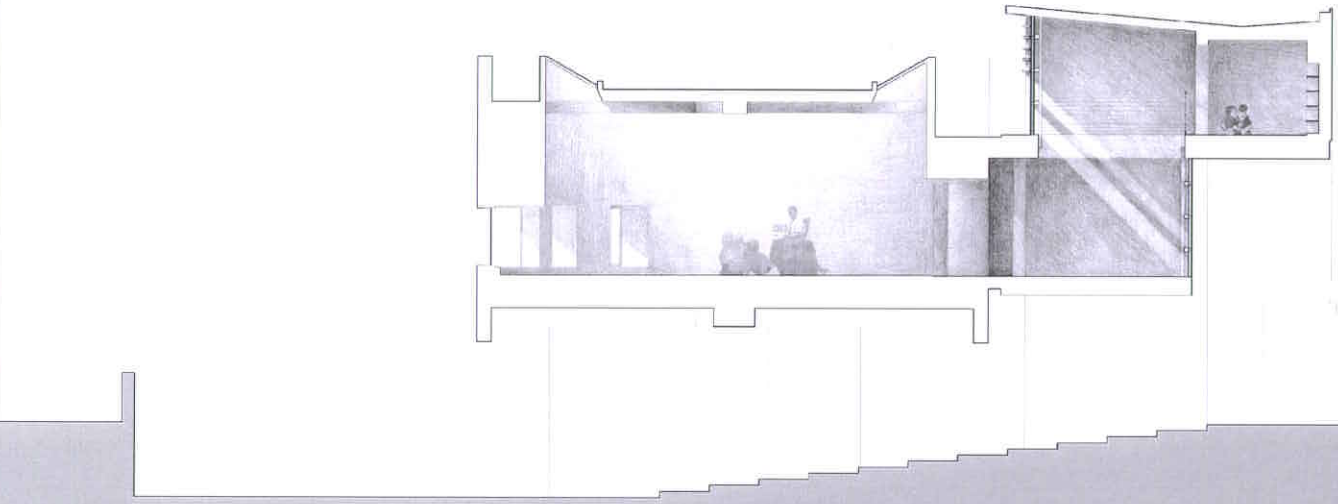
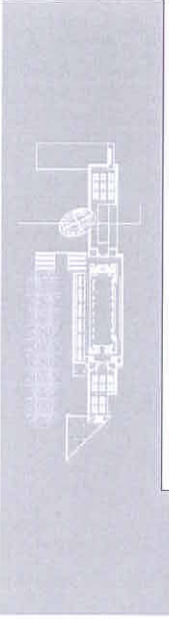
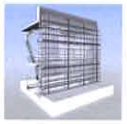

Section Looking West
1/4" = 1'-0"

EXPERIENCING

EXPERIENCING

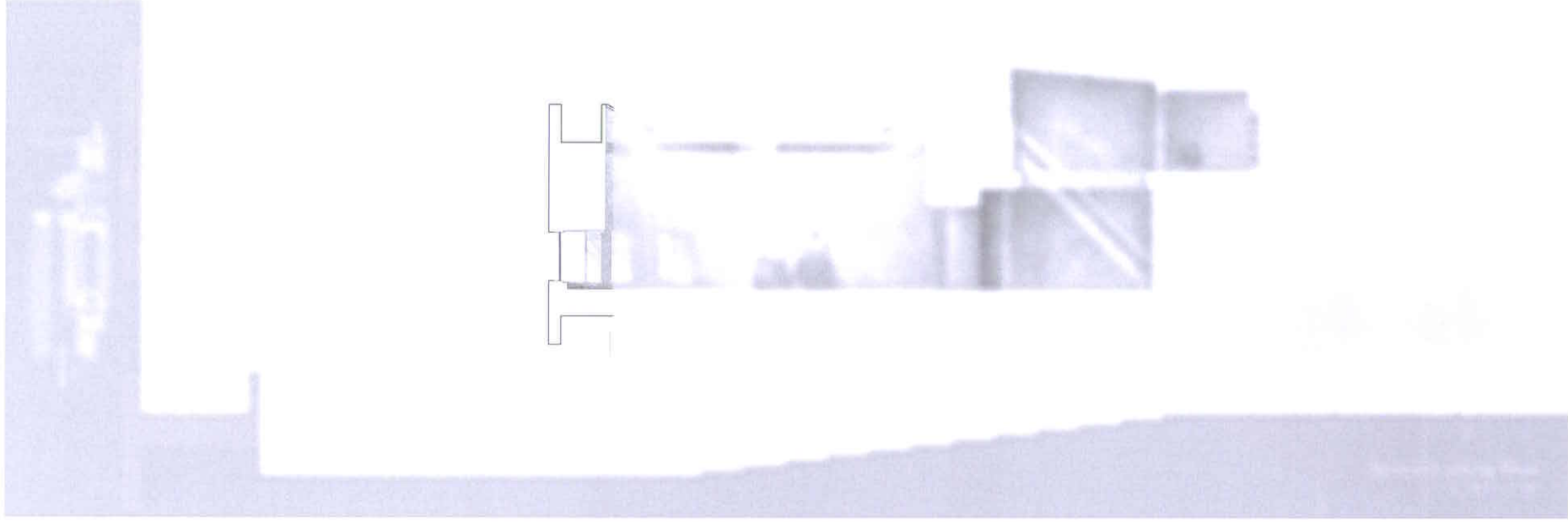

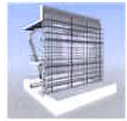

EXPERIENCING

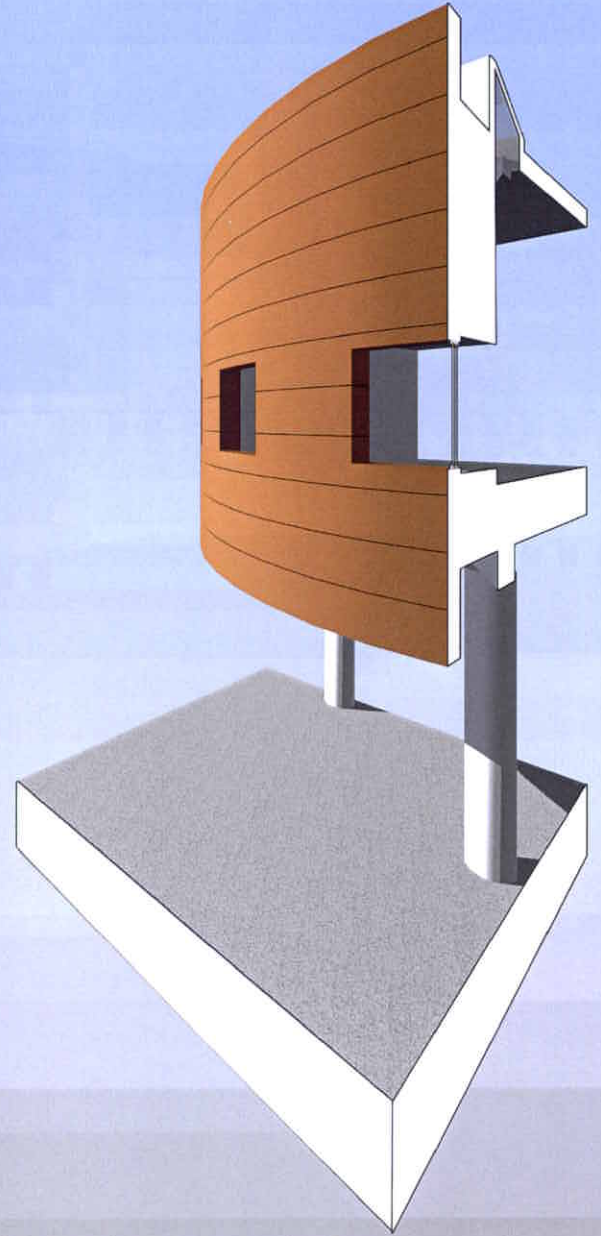
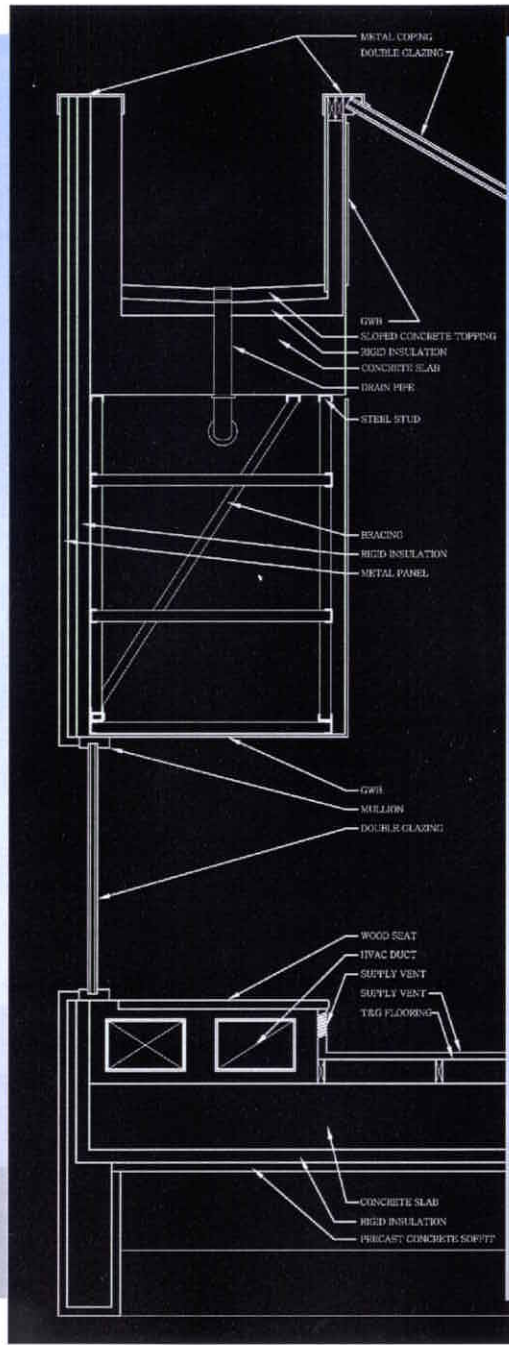
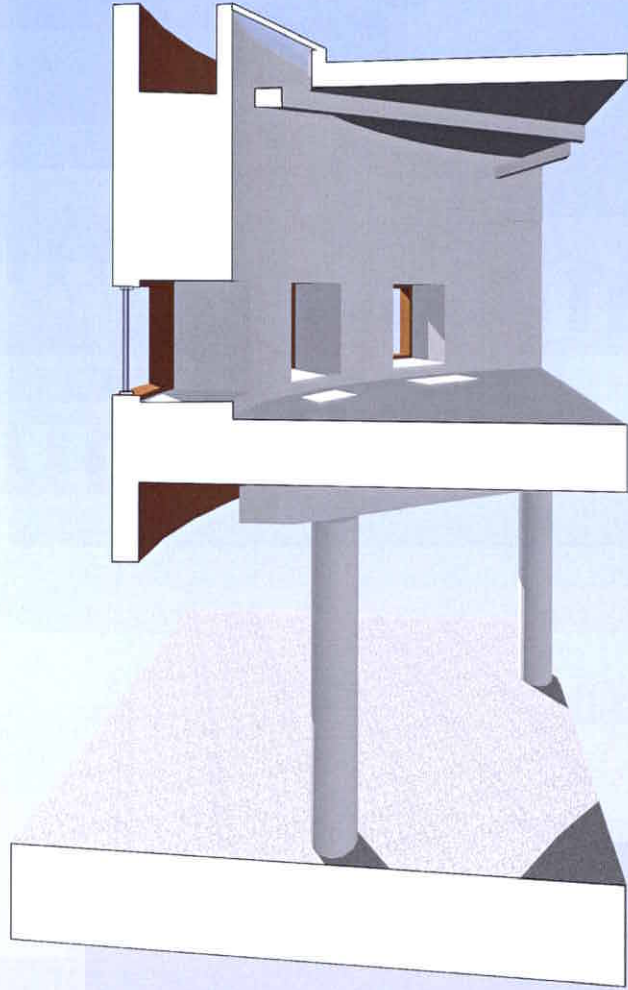

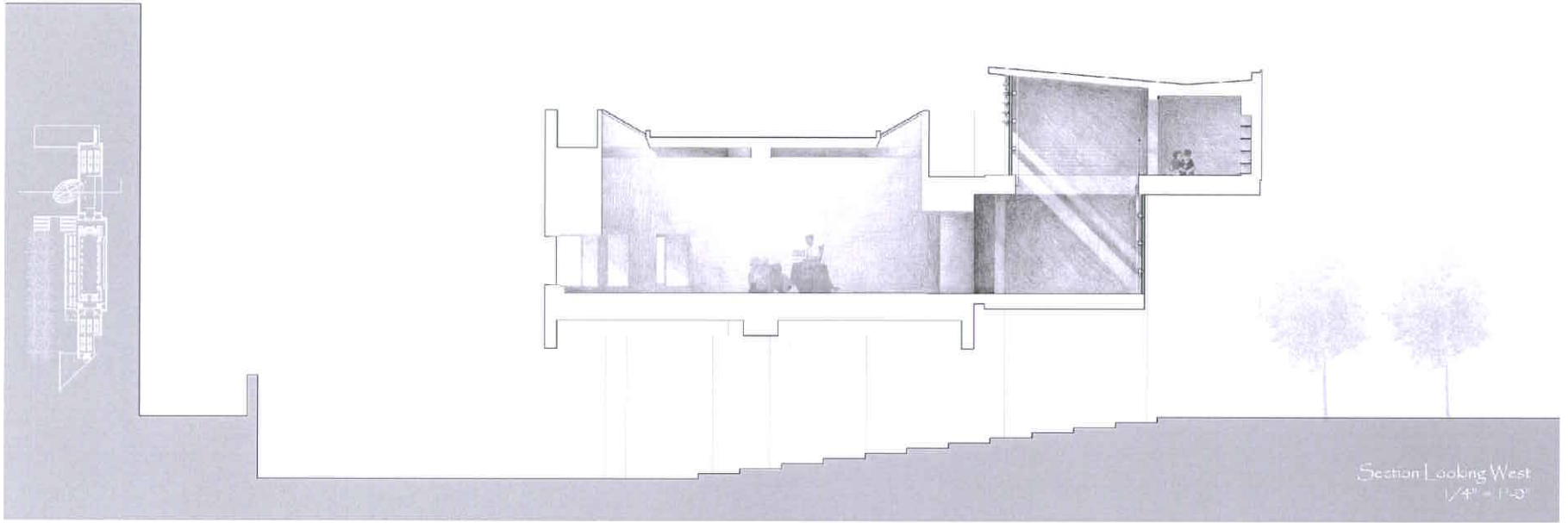

EXPERIENCING

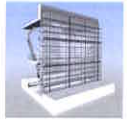

EXPERIENCING



EXPERIENCING

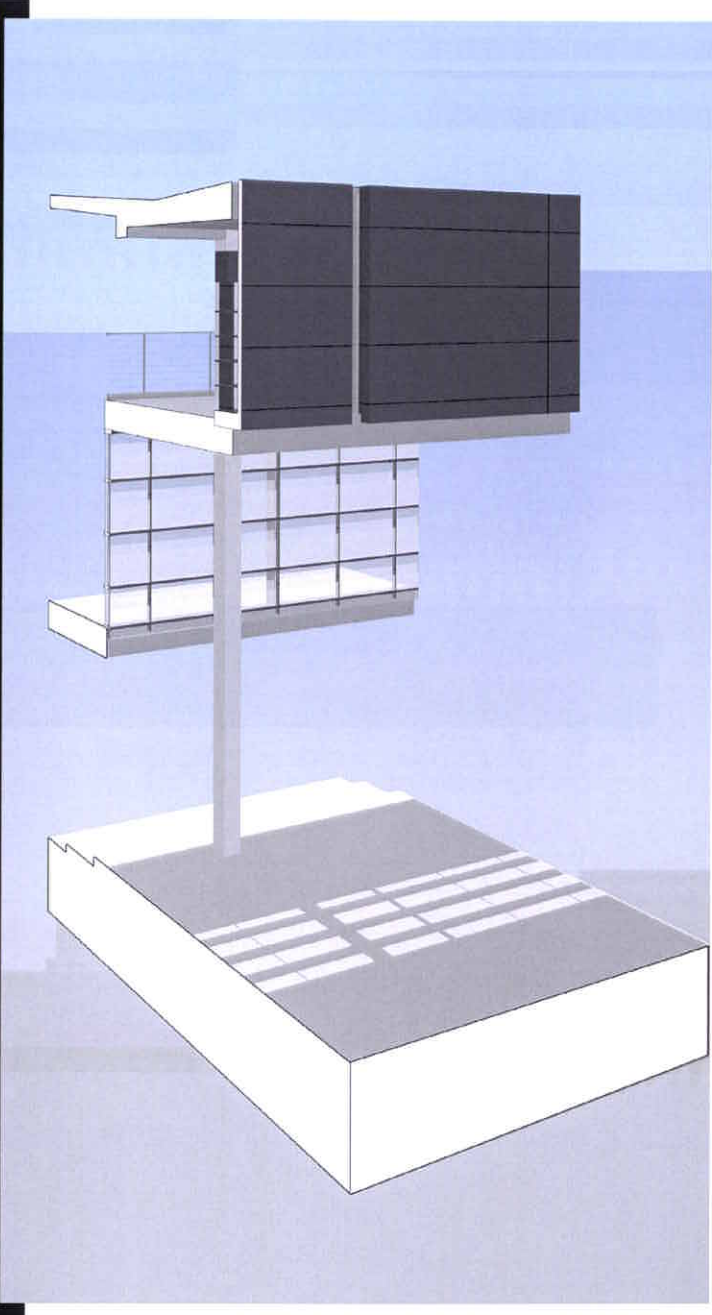
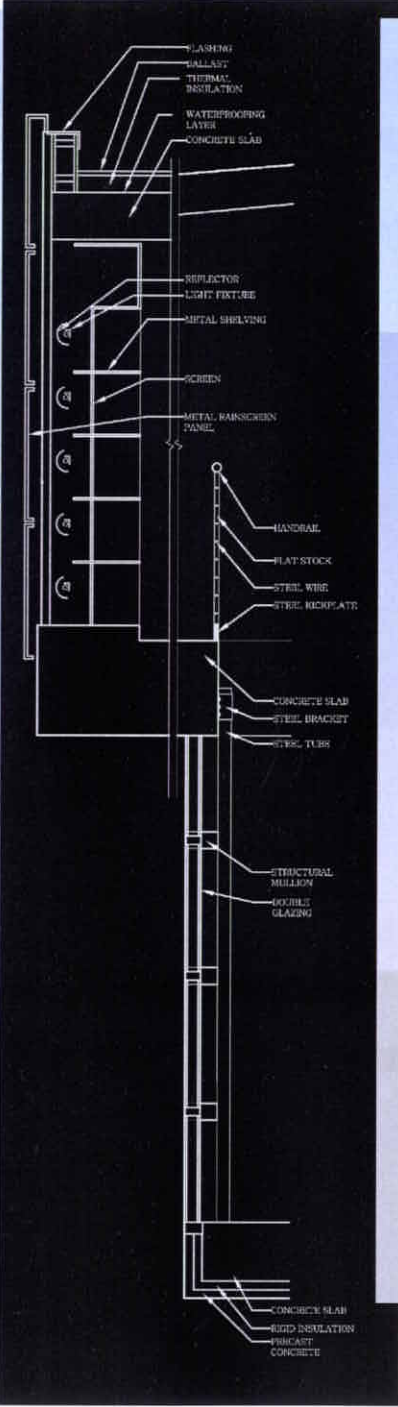
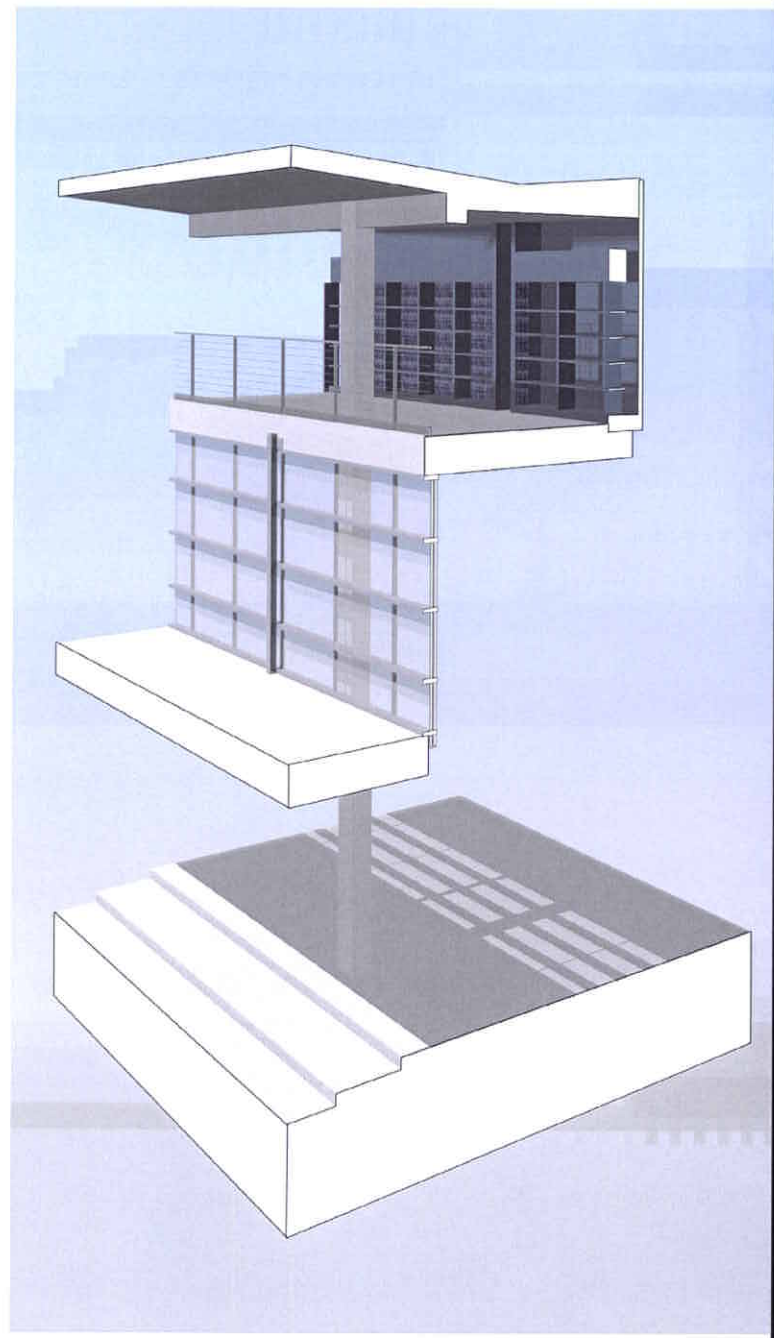

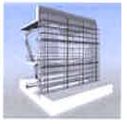

EXPERIENCING

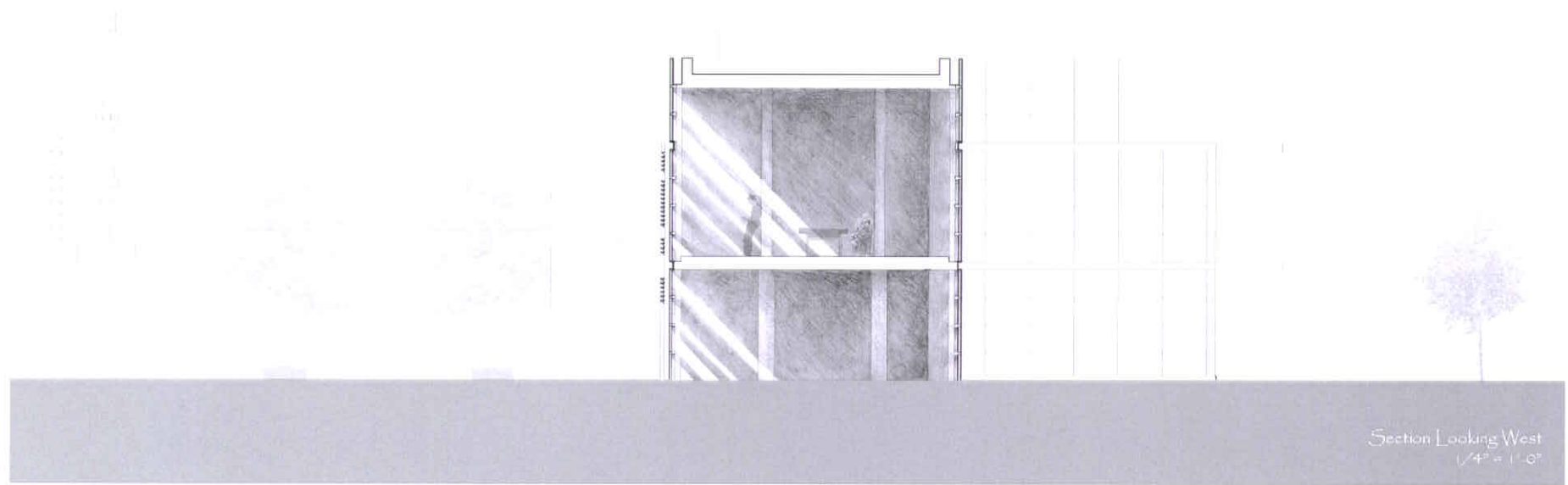

Section Looking West
1/4" = 1'-0"

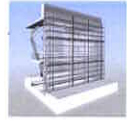

EXPERIENCING

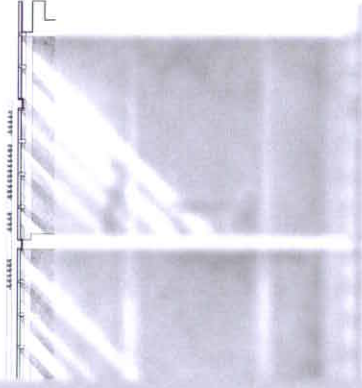

www.ingegneri.com

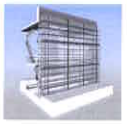

EXPERIENCING

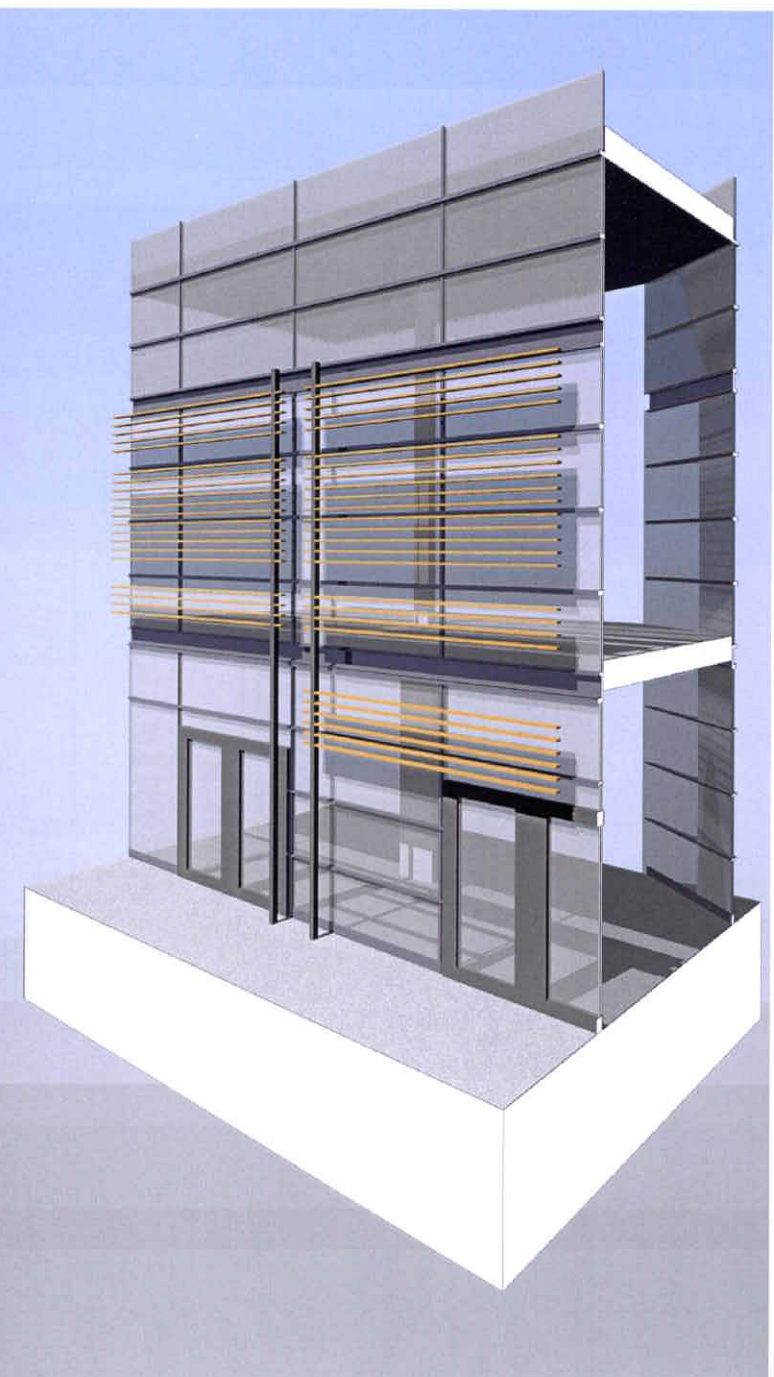
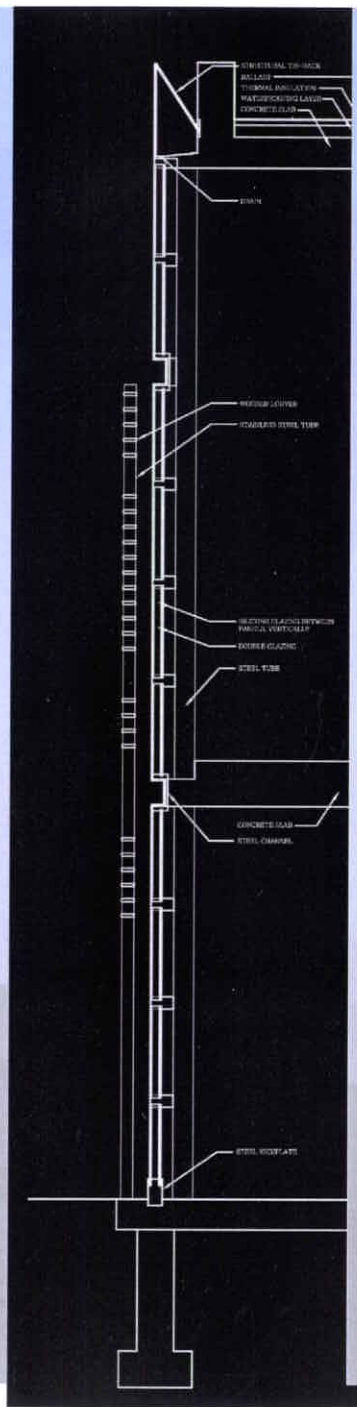
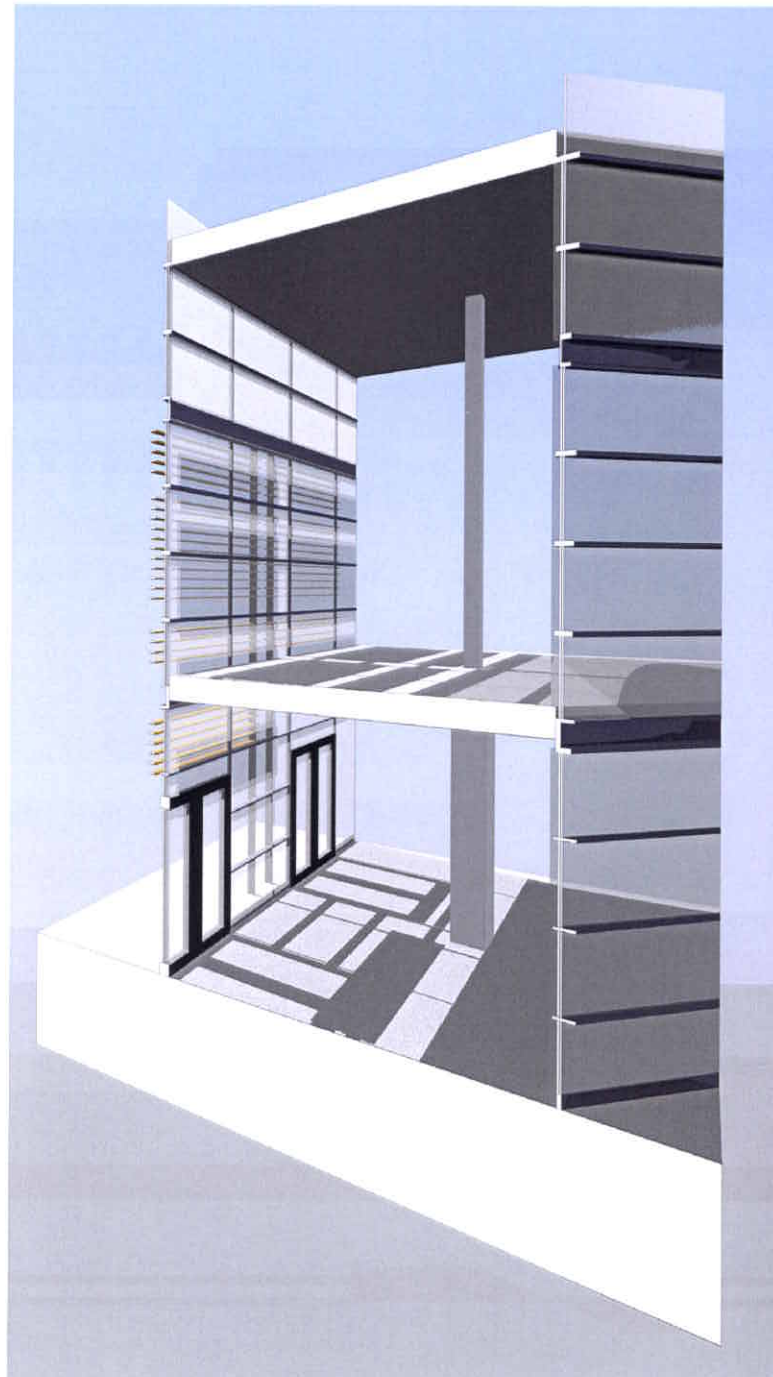

EXPLORING



PROGRAM

SITE

GESAMTKUNSTWERK

DESIGN

EXPERIENCING

ILLUMINATION

CONCLUSION

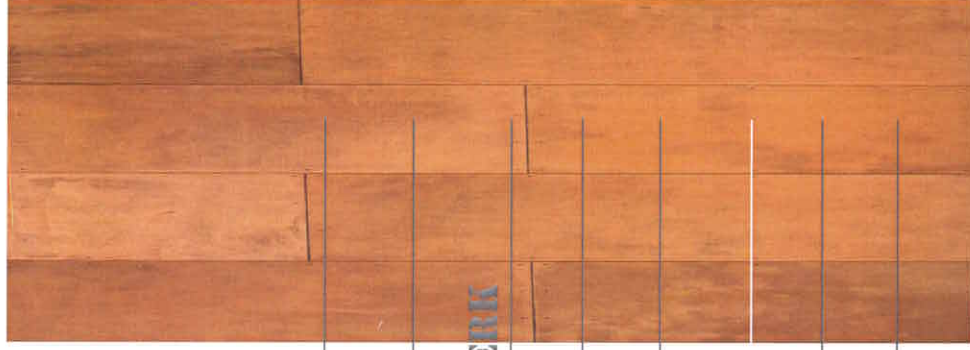



EXPLORING



EXPLORING

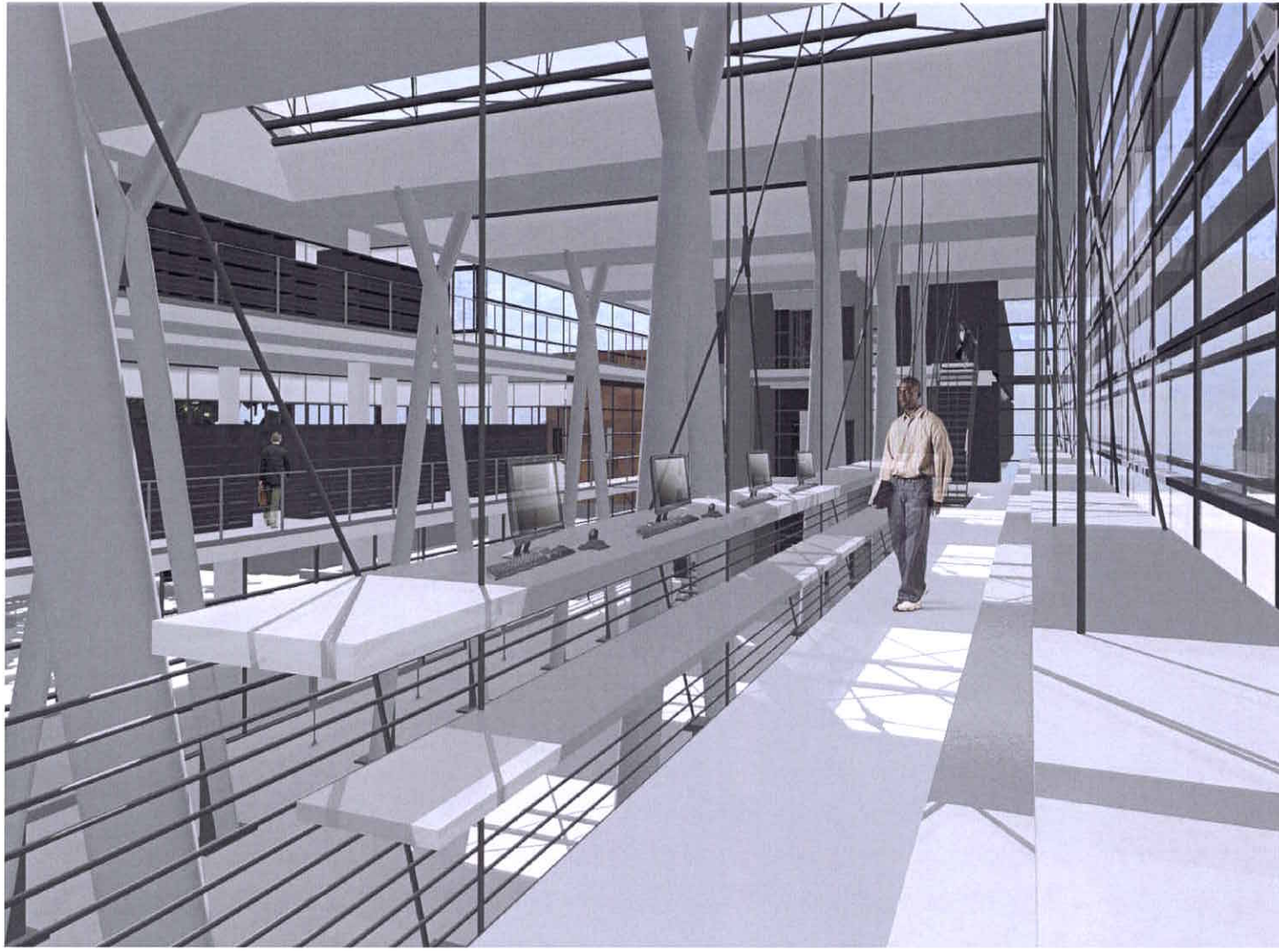



EXPLORING





EXPLORING





EXPLORING

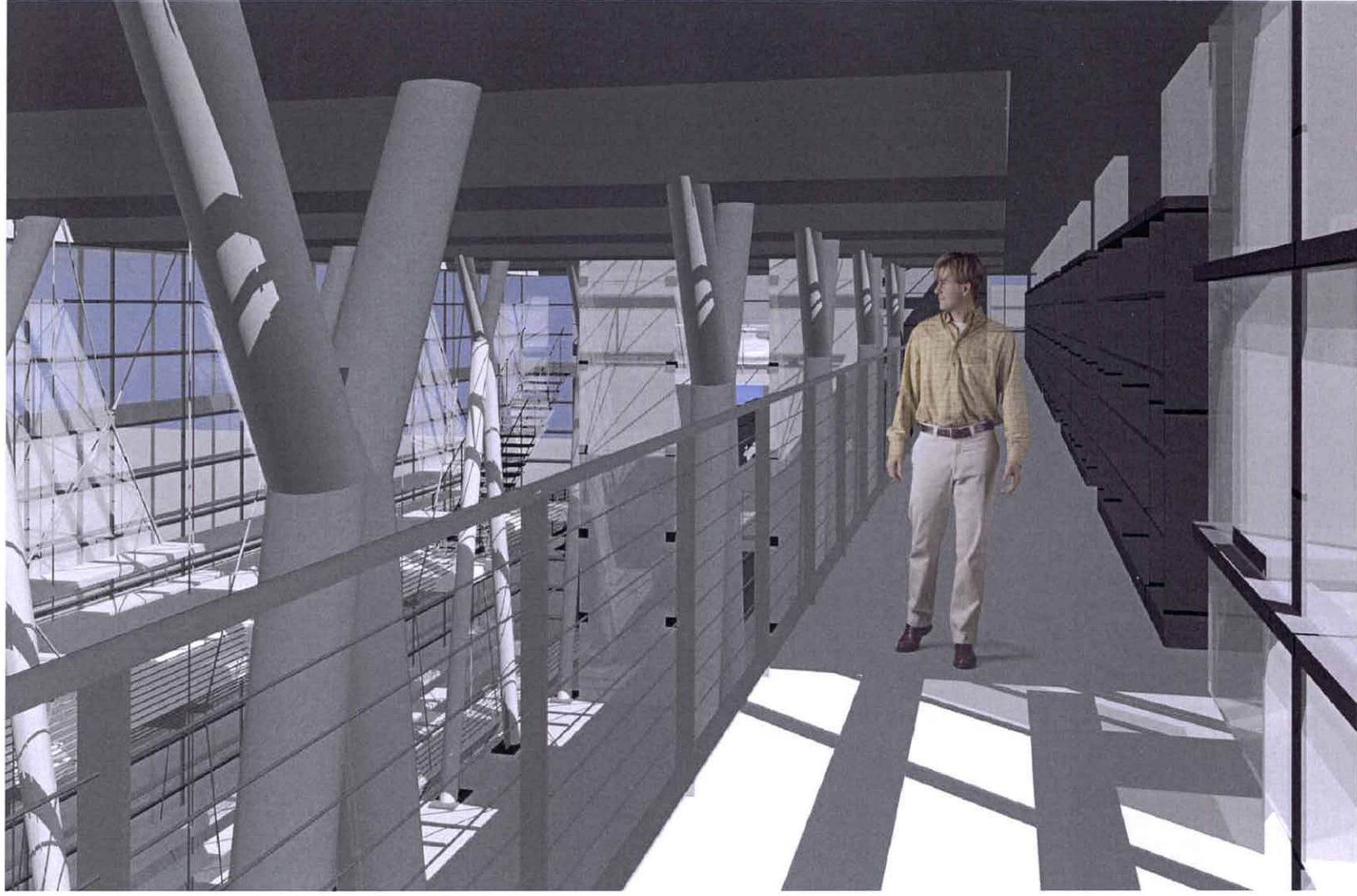

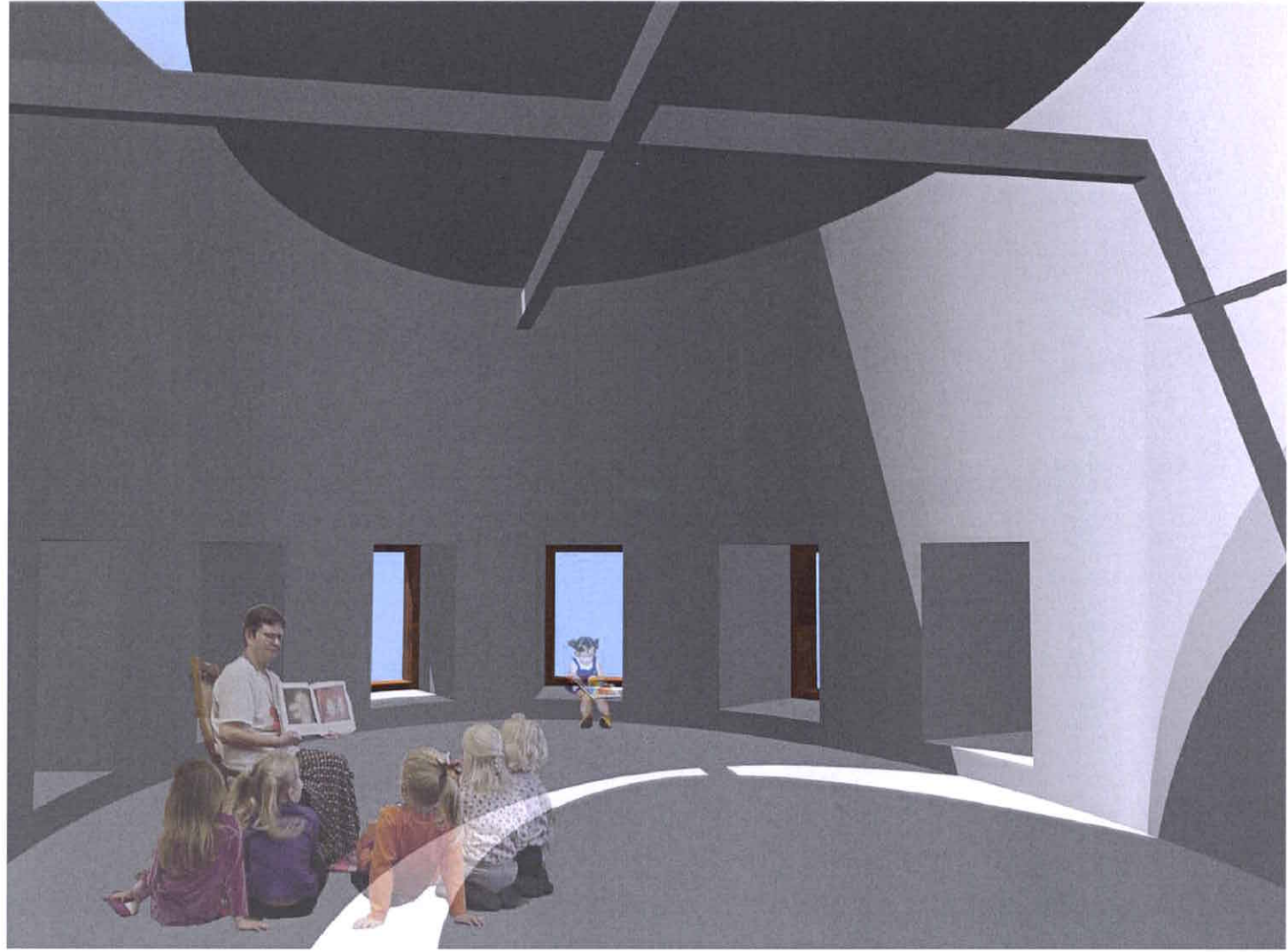

EXPLORING



EXPLORING

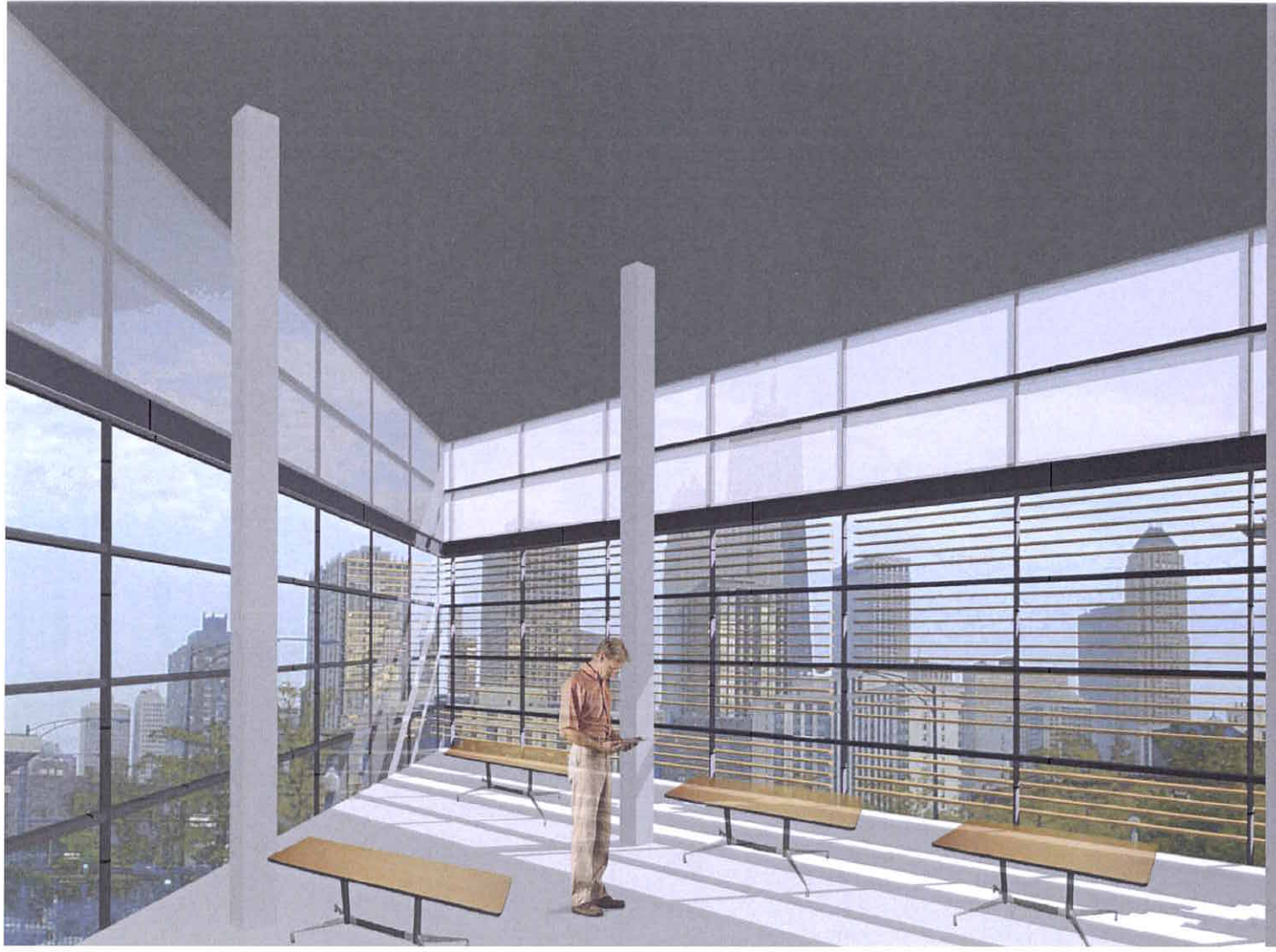



EXPLORING





EXPLORING





EXPLORING



ILLUMINATION



PROGRAM

SITE

GESAMTKUNSTWERK

DESIGN

EXPERIENCING

EXPLORING

CONCLUSION

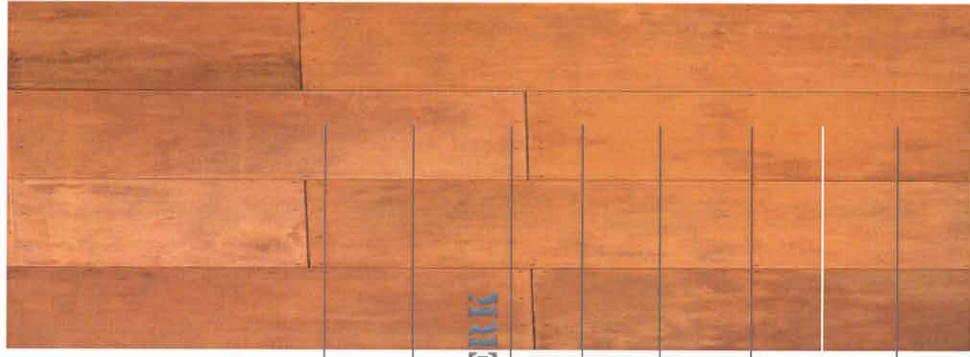

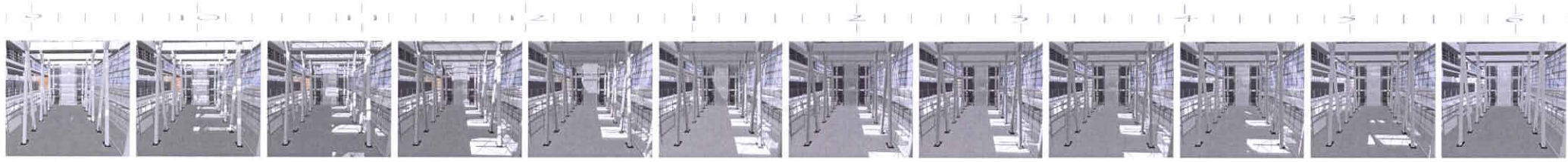
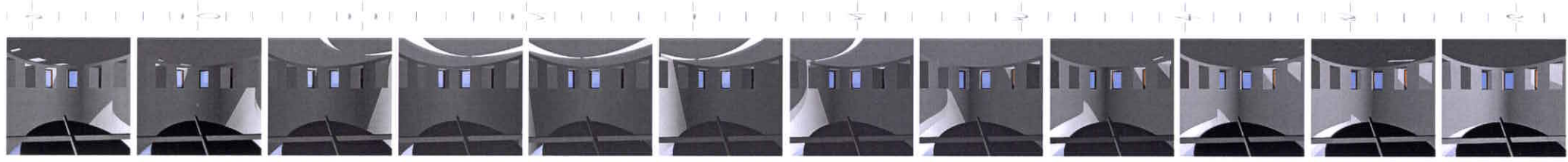

ILLUMINATION

CONCLUSION

PROGRAM	
SITE	
GESAMPTKUNSTWERK	
DESING	
EXPERIENCING	
EXPLORING	
ILLUMINATION	

CONCLUSION

As this thesis project evolved, it became an investigation of the experience of space; an exercise in creating a series of spaces which could handle as well as promote the positive activities of reading, mentoring, and exploring among others. The notion that this library could be the cornerstone in the redevelopment of a community required that the users and their interaction with the space be held at the forefront of design.



CHRIS OCKEN
Standing with Leslie Hunter, leader of Holy Family Lutheran Church's Boys in the Hood (center) are (clockwise from left) Anthony Fisher, Curtis Miller, Dimontie Wallace, Joe Reed, Deon Hale and Ned Lewis.